



Asbestos Assessment

St. David
33 Cromwell Crescent, Hamilton,
ON, L8G 2E9

Prepared for:

**Hamilton-Wentworth Catholic
District School Board**

90 Mulberry Street
Hamilton, Ontario, L8N 3R9

August 31, 2023

Pinchin File: 320582.004



Asbestos Assessment

St. David, 33 Cromwell Crescent, Hamilton, ON, L8G 2E9
Hamilton-Wentworth Catholic District School Board

August 31, 2023
Pinchin File: 320582.004

Issued to: Hamilton-Wentworth Catholic District School Board
Issued on: August 31, 2023
Pinchin File: 320582.004
Issuing Office: Hamilton, ON
Primary Contact: Emily Balfour, Project Manager, ebalfour@pinchin.com

Author:

Emily Balfour
Project Manager
365.889.5147
ebalfour@pinchin.com

Reviewer:

Damian Palus, C.E.T.
Operations Manager
289.678.0694
dpalus@pinchin.com



EXECUTIVE SUMMARY

Hamilton-Wentworth Catholic District School Board (Client) retained Pinchin Ltd. (Pinchin) to conduct an asbestos building materials assessment of St. David located at 33 Cromwell Crescent, Hamilton, ON, L8G 2E9.

The objectives of the assessment were to document the locations of asbestos building materials, evaluate their condition and develop corrective action plans as required for the purposes of long-term management. The results of this assessment are not intended for construction, renovation, demolition or project tendering purposes.

SUMMARY OF RECOMMENDATIONS

The following is a summary of significant recommendations; refer to the body of the report for detailed recommendations:

1. Maintain the Asbestos Management Program (AMP)
2. Perform a re-assessment of asbestos materials on an annual basis.
3. Perform a pre-construction assessment and remove all ACM prior to alteration or maintenance work if ACM may be disturbed by the work.
4. Follow appropriate safe work procedures when handling or disturbing asbestos.
5. Sample any presumed ACM prior to alteration or maintenance work if presumed ACM may be disturbed by the work.
6. Update the asbestos inventory report upon completion of any abatement and removal of asbestos-containing materials.

This Executive Summary is subject to the same standard limitations as contained in the report and must be read in conjunction with the entire report.



TABLE OF CONTENTS

1.0	INTRODUCTION AND SCOPE	1
1.1	Scope of Assessment	1
2.0	METHODOLOGY	1
3.0	BACKGROUND INFORMATION	1
3.1	Building Year of Construction and Additions	1
3.2	Existing Reports	1
3.3	Inaccessible Locations	2
4.0	FINDINGS	2
4.1	Excluded Asbestos Materials	2
4.2	Summary of Building Materials	3
5.0	RECOMMENDATIONS	4
5.1	General	4
5.2	Remedial Work	5
5.3	On-going Management and Maintenance	5
6.0	TERMS AND LIMITATIONS	5
7.0	REFERENCES	6

APPENDICES

APPENDIX I	Drawings
APPENDIX II	Asbestos Analytical Certificates
APPENDIX III	Methodology
APPENDIX IV	Location List
APPENDIX V	Summary Report / Sample Log
APPENDIX VI	HMIS All Data Report



1.0 INTRODUCTION AND SCOPE

Hamilton-Wentworth Catholic District School Board (Client) retained Pinchin Ltd. (Pinchin) to conduct an asbestos building materials assessment of St. David located at 33 Cromwell Crescent, Hamilton, ON, L8G 2E9.

Pinchin performed the assessment on July 25, 2023.

The objectives of the assessment were to document the locations of asbestos building materials, evaluate their condition and develop corrective action plans as required. This assessment is only to be used for the purposes of long-term management and routine maintenance. The results of this assessment are not to be used for construction, renovation, demolition, or project tendering purposes.

1.1 Scope of Assessment

The assessment was performed to establish the location and type of asbestos building materials incorporated in the structure(s) and its finishes. The **assessed area** consisted of all parts of the building, excluding the roof.

2.0 METHODOLOGY

Pinchin conducted a room-by-room assessment (rooms, corridors, service areas, exterior, etc.) to identify the asbestos-containing building materials as defined in the scope.

The assessment was limited to non-intrusive testing. Concealed spaces such as those above solid ceilings and within shafts and pipe chases were accessed via existing access panels only. Demolition of walls, solid ceilings, structural items, interior finishes or exterior building finishes, to determine the presence of concealed materials was not conducted.

For further details on the methodology including test methods, refer to Appendix III.

3.0 BACKGROUND INFORMATION

3.1 Building Year of Construction and Additions

Item	Details
Year of Construction	1970

3.2 Existing Reports

Pinchin previously prepared the following report, which has been reviewed as part of this assessment:

- Asbestos Reassessment Report, St. David, August 2022, Pinchin File No. 303992.004.



3.3 Inaccessible Locations

Inaccessible locations (rooms or areas), if any, are indicated in the Location List Report in Appendix IV. These locations within the assessed area were not accessible to the surveyor and are therefore not included in the report.

4.0 FINDINGS

The following section summarizes the findings of the assessment and provides a general description of the asbestos-containing materials (ACM) identified and their locations. For details on approximate quantities, condition, friability, accessibility and locations of asbestos materials; refer to the Asbestos Material Summary Report and All Data Report in Appendix V and VI.

4.1 Excluded Asbestos Materials

A number of materials which might contain asbestos were not sampled during this assessment due to limitations in scope and methodology. Where present, these materials are assumed to contain asbestos until otherwise proven by sampling and analysis. These materials are not shown on the drawings in Appendix I. Excluded materials presumed to contain asbestos include:

- Roofing felts and tar, mastics
- Floor levelling compound
- Ceramic tile setting compound
- Elevator and lift brakes
- Electrical components
- Mechanical packing, ropes and gaskets
- Vermiculite
- Adhesives and duct mastics
- Caulking and putties
- Fibre-reinforced paints and coatings
- Paper products
- Soffit and fascia boards
- Fire resistant doors
- Vibration dampers on HVAC equipment
- Terrazzo
- Ropes and gaskets in cast-iron bell and spigot joints



- Sealants on pipe threads



4.2 Summary of Building Materials

This section includes a summary of building materials that have been confirmed asbestos-containing by sample analysis, presumed asbestos-containing by visual identification, or confirmed non-asbestos by sampling or based on the manufacture date and known end of use of asbestos in these products.

The locations of samples from historical assessments performed by Pinchin, have been included on the drawings.

Appendix II presents the asbestos bulk sample analytical results.

Material and Application	Asbestos Type	Photo
Texture finish is present on drywall walls in the Chapel (Location 1016).	None	
Parging cement is present on pipe fittings (elbows, valves, tees, hangers etc.).	None	
Remaining pipes are either uninsulated or insulated with non-asbestos fibreglass or elastomeric insulation (Armaflex).	None	
Ducts are either uninsulated or insulated with non-asbestos fibreglass (foil-faced or canvas).	None	
Mechanical equipment is either uninsulated or insulated with non-asbestos fibreglass.	None	
All ceiling tiles are presumed to be non-asbestos based on the date of manufacture determined from the date stamp applied to the top of the tiles and the age of the materials determined from the age of the building.	None	
Plaster is present on walls and ceilings.	None	
Drywall joint compound is present on wall and ceiling finishes.	None	

Material and Application	Asbestos Type	Photo
<p>Vinyl floor tiles, 12"x12" light green multi-fleck and 12"x12" green multi-fleck, are present.</p>	<p>None (tile) None (mastic)</p>	
<p>Remaining vinyl floor tiles are presumed to be non-asbestos based on historical knowledge of the date of installation.</p> <p>Mastic under non-asbestos tiles is presumed to contain asbestos until further sampling is performed.</p>	<p>None (tile) Presumed (mastic)</p>	

Additional notes on the drywall joint compound discussed above:

- Drywall (gypsum board) and drywall joint compound is present as a wall and ceiling finish throughout the building. As per the methodology, drywall joint compound is sampled at exterior walls, columns or other locations that are unlikely to have been renovated in an attempt to determine the presence of asbestos in the original drywall compound. A total of 9 samples of drywall joint compound were collected (samples S0001A-C, S0002A-C, and S0004A-C, lab reference no. 71918923) and it was found that all samples do not contain asbestos. Therefore, drywall joint compound present on drywall finishes should be considered to be non-asbestos.

5.0 RECOMMENDATIONS

5.1 General

Perform a detailed intrusive assessment prior to maintenance work, building renovation or demolition operations. The assessment should include destructive testing (e.g., coring and/or removal of building



finishes and components), and other hazardous materials (lead, mercury, PCBs, mould, etc.) and materials not tested in this study (e.g., roofing materials, caulking, mastics).

5.2 Remedial Work

No remedial work is recommended.

5.3 On-going Management and Maintenance

The following recommendations are made regarding on-going management and maintenance work involving the asbestos materials identified.

Maintain the Asbestos Management Program (AMP).

Perform a reassessment of asbestos materials on an annual basis.

Remove asbestos-containing materials (ACM) prior to alteration or maintenance work if ACM may be disturbed by the work. Follow appropriate asbestos precautions for the classification of work being performed.

Sample presumed ACM prior to alteration or maintenance work if the presumed ACM may be disturbed by the work.

Update the asbestos inventory report upon completion of any abatement and removal of asbestos-containing materials.

6.0 TERMS AND LIMITATIONS

This work was performed subject to the Terms and Limitations presented or referenced in the proposal for this project.

Information provided by Pinchin is intended for Client use only. Pinchin will not provide results or information to any party unless disclosure by Pinchin is required by law. Any use by a third party of reports or documents authored by Pinchin or any reliance by a third party on or decisions made by a third party based on the findings described in said documents, is the sole responsibility of such third parties. Pinchin accepts no responsibility for damages suffered by any third party as a result of decisions made or actions conducted. No other warranties are implied or expressed.



7.0 REFERENCES

The following legislation and documents were referenced in completing the assessment and this report:

1. Asbestos on Construction Projects and in Buildings and Repair Operations, Ontario Regulation 278/05.
2. Designated Substances, Ontario Regulation 490/09.
3. Ministry of the Environment Regulation, R.R.O. 1990 Reg. 347 as amended.

\\PIN-HAM-FS02\job\320000s\0320582.000 HWCDSB,Various2023Projects,ASB,CONS\0320582.004 HWCDSB,AllSites,2023,ASB,ASSMT\Deliverables\St. David\Deliverables\320582.004 Asbestos Asmnt Report St. David HWCDSB Aug 31 2023.docx

Template: Master Report for Asbestos Assessment, HAZ, July 29, 2021

APPENDIX I
Drawings

NOT ALL KNOWN OR SUSPECTED ASBESTOS BUILDING MATERIALS MAY BE DEPICTED ON THE DRAWING. REFER TO THE ASBESTOS REASSESSMENT REPORT FOR A COMPLETE LIST OF KNOWN AND SUSPECTED ASBESTOS BUILDING MATERIALS.

LEGEND IS COLOUR DEPENDENT. NON-COLOUR COPIES MAY ALTER INTERPRETATION.

BASE PLAN PROVIDED BY CLIENT.



905-577-6206

www.pinchin.com

LEGEND:

(X) LOCATION NUMBER

(◎) ASBESTOS BULK SAMPLE

ASBESTOS-CONTAINING MATERIALS:

MASTIC

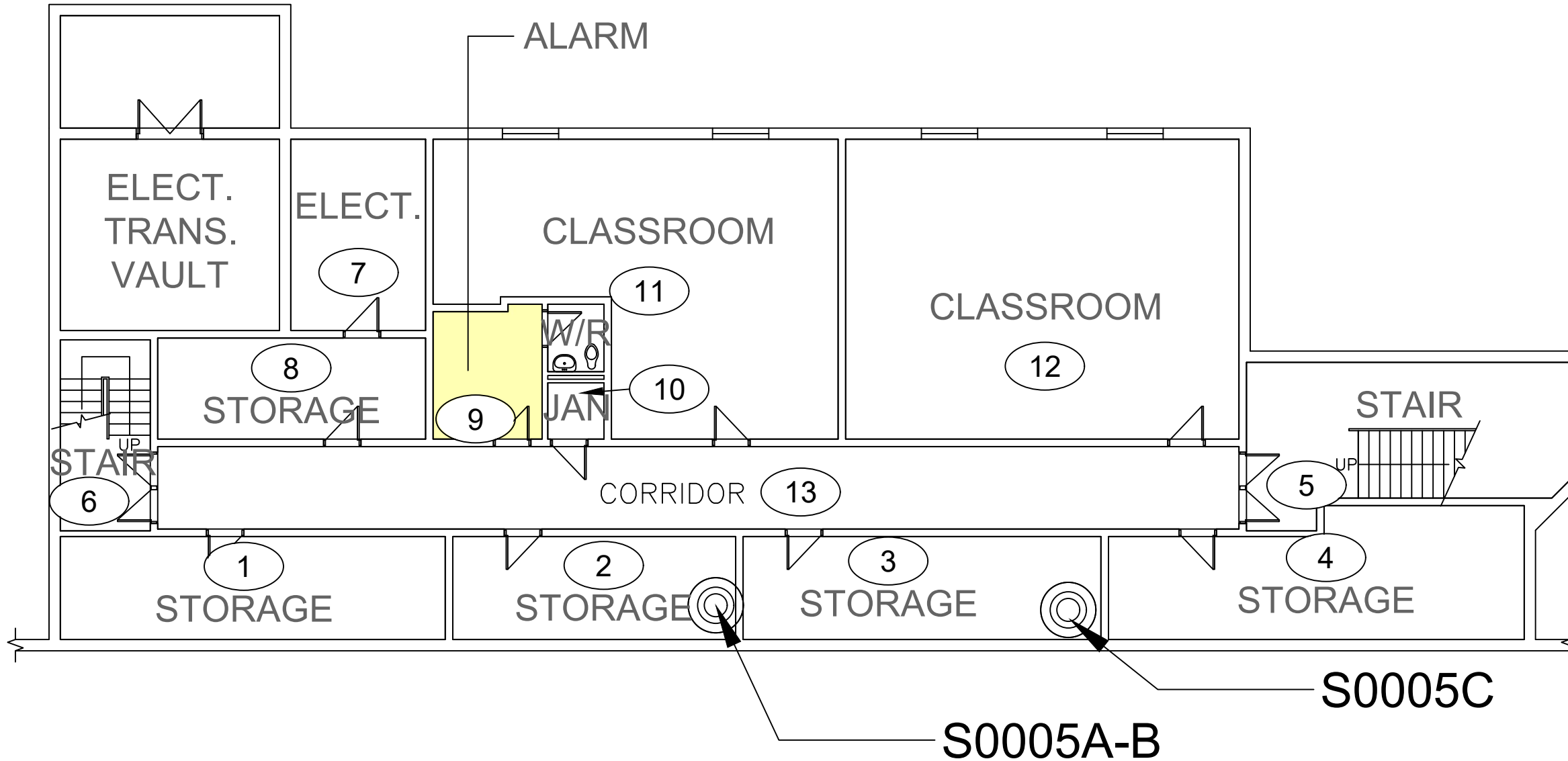

CLIENT:



LOCATION:

ST. DAVID
33 CROMWELL CRESCENT
HAMILTON, ONTARIO

TITLE:

ASBESTOS ASSESSMENT
BASEMENT

DATE:

AUGUST 2023

PROJECT #:

320582.004

DRAWN BY:

EB

DRAWING:

CHECKED BY:

EB

1 OF 3

SCALE:

NTS

NOT ALL KNOWN OR SUSPECTED ASBESTOS BUILDING MATERIALS MAY BE DEPICTED ON THE DRAWING. REFER TO THE ASBESTOS REASSESSMENT REPORT FOR A COMPLETE LIST OF KNOWN AND SUSPECTED ASBESTOS BUILDING MATERIALS.

LEGEND IS COLOUR DEPENDENT. NON-COLOUR COPIES MAY ALTER INTERPRETATION.

BASE PLAN PROVIDED BY CLIENT.

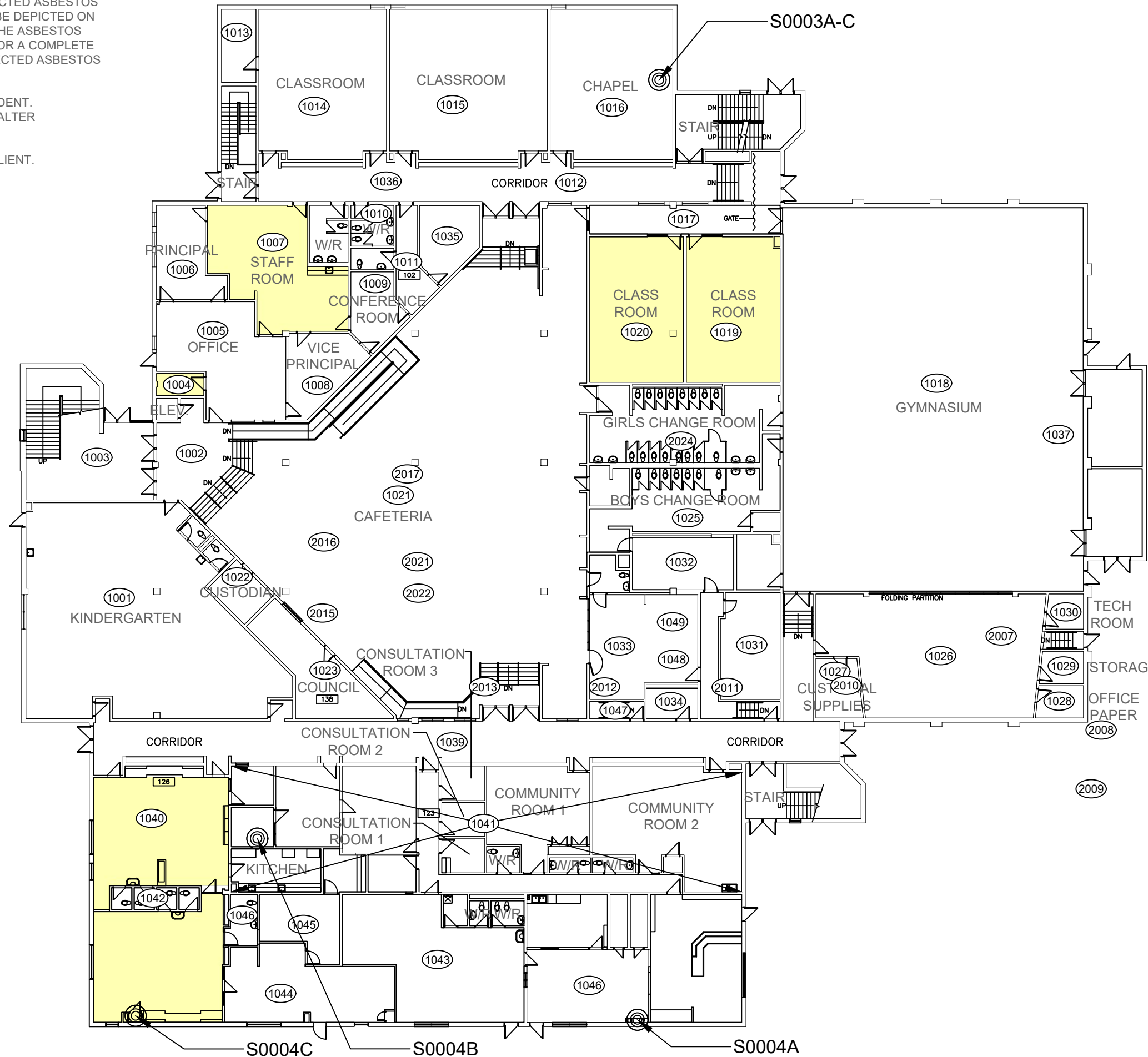

905-577-6206 www.pinchin.com

LEGEND:

- (X) LOCATION NUMBER
- (O) ASBESTOS BULK SAMPLE

ASBESTOS-CONTAINING MATERIALS:

MASTIC

CLIENT:



LOCATION:

ST. DAVID
33 CROMWELL CRESCENT
HAMILTON, ONTARIO

TITLE:

ASBESTOS ASSESSMENT
FIRST FLOOR

DATE:

AUGUST 2023

PROJECT #:

320582.004

DRAWN BY:

EB

CHECKED BY:

EB

SCALE:

NTS

DRAWING:

2 OF 3

NOT ALL KNOWN OR SUSPECTED ASBESTOS BUILDING MATERIALS MAY BE DEPICTED ON THE DRAWING. REFER TO THE ASBESTOS REASSESSMENT REPORT FOR A COMPLETE LIST OF KNOWN AND SUSPECTED ASBESTOS BUILDING MATERIALS.

LEGEND IS COLOUR DEPENDENT. NON-COLOUR COPIES MAY ALTER INTERPRETATION.

BASE PLAN PROVIDED BY CLIENT.



905-577-6206 www.pinchin.com

LEGEND:

(X) LOCATION NUMBER

(⊙) ASBESTOS BULK SAMPLE

ASBESTOS-CONTAINING MATERIALS:

MASTIC

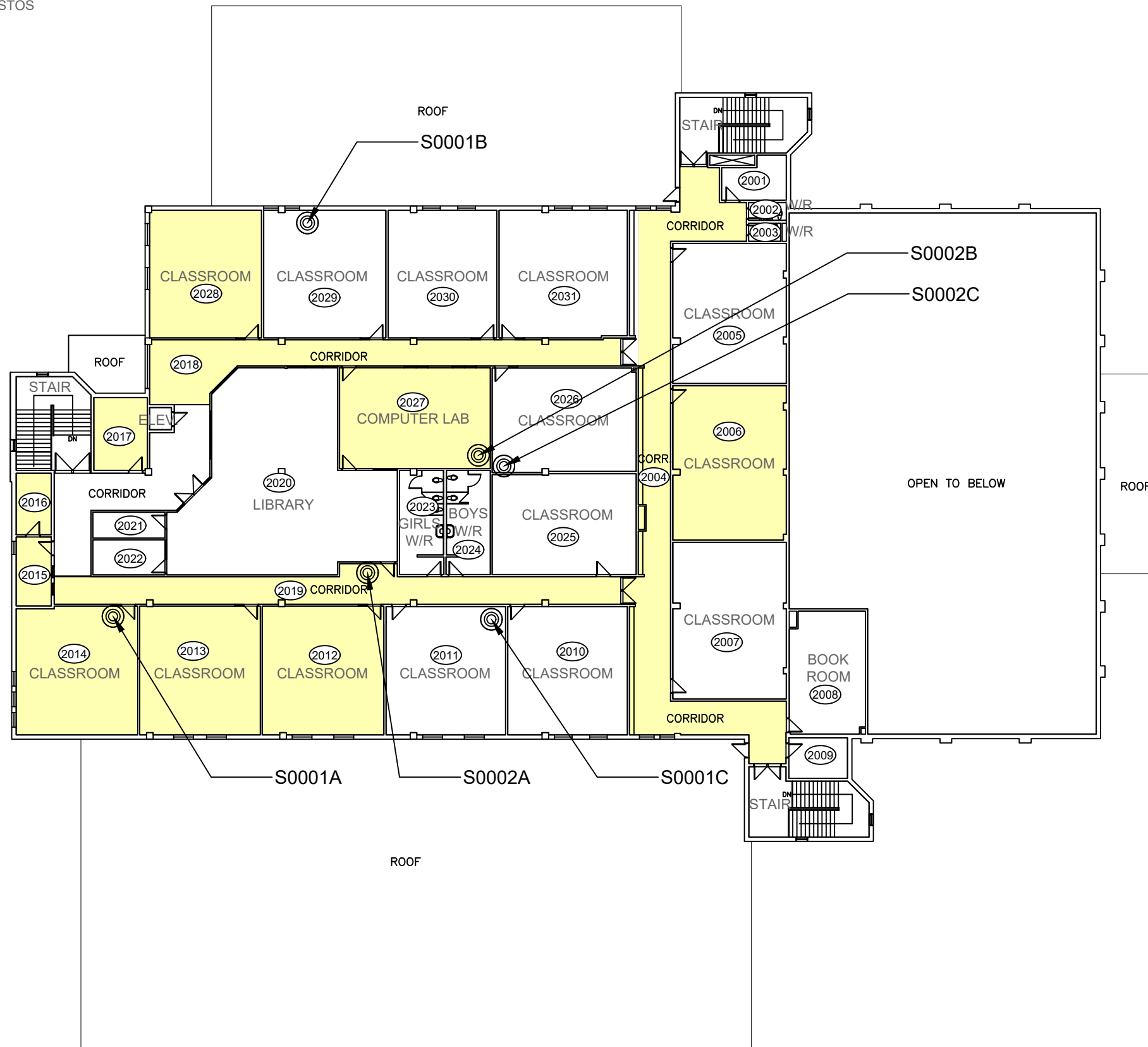

CLIENT:



Hamilton-Wentworth
Catholic District School Board
Believing. Achieving. Serving.

LOCATION:
ST. DAVID
33 CROMWELL CRESCENT
HAMILTON, ONTARIO

TITLE:
ASBESTOS ASSESSMENT
SECOND FLOOR

DATE: AUGUST 2023	PROJECT # : 320582.004
----------------------	---------------------------

DRAWN BY: EB	DRAWING: 3 OF 3
CHECKED BY: EB	
SCALE: NTS	

APPENDIX II
Asbestos Analytical Certificates



Bulk Asbestos Analysis

By Polarized Light Microscopy
 EPA Method: 600/R-93/116 and 40 CFR, Part 763, Subpart E,
 App.E



Customer: Pinchin Ltd.
 6-875 Main St West
 Suite 200
 Hamilton, Ontario L8S 4P9

Attn: Emily Balfour
 Michael Maiorana

Lab Order ID: 71918923
Analysis ID: 71918923_PLM
Date Received: 7/18/2019
Date Reported: 7/23/2019

Project: 230748,33 Cromwell Crescent, Hamilton, Ontario,Hamilton-Wentworth Catholic School Board,St. David

Sample ID	Description	Asbestos	Fibrous Components	Non-Fibrous Components	Attributes
Lab Sample ID	Lab Notes				Treatment
S0001A	Drywall Joint Compound on Wall, Classroom, Location 2014	None Detected		100% Other	White Non Fibrous Homogeneous
71918923PLM_1					Crushed
S0001B	Drywall Joint Compound on Wall, Classroom, Location 2029	None Detected		100% Other	White Non Fibrous Homogeneous
71918923PLM_2					Crushed
S0001C	Drywall Joint Compound on Wall, Classroom, Location 2011	None Detected		100% Other	White Non Fibrous Homogeneous
71918923PLM_3					Crushed
S0002A	Drywall Joint Compound on Wall, Library, Location 2020	None Detected		100% Other	White Non Fibrous Homogeneous
71918923PLM_4					Crushed
S0002B	Drywall Joint Compound on Wall, Computer Lab, Location 2027	None Detected		100% Other	White Non Fibrous Homogeneous
71918923PLM_5					Crushed
S0002C	Drywall Joint Compound on Wall, Classroom, Location 2026	None Detected		100% Other	White Non Fibrous Homogeneous
71918923PLM_6					Crushed
S0003A	Texture Finish on Wall, Chapel, Location 1016	None Detected		100% Other	White Non Fibrous Homogeneous
71918923PLM_7					Crushed
S0003B	Texture Finish on Wall, Chapel, Location 1016	None Detected		100% Other	White Non Fibrous Homogeneous
71918923PLM_8					Crushed

Disclaimer: Due to the nature of the EPA 600 method, asbestos may not be detected in samples containing low levels of asbestos. We strongly recommend that analysis of floor tiles, vermiculite, and/or heterogeneous soil samples be conducted by TEM for confirmation of "None Detected" by PLM. This report relates only to the samples tested and may not be reproduced, except in full, without the written approval of SAL. This report may not be used by the client to claim product endorsement by NVLAP or any other agency of the U.S. government. Analytical uncertainty available upon request. Scientific Analytical Institute participates in the NVLAP Proficiency Testing program. Unless otherwise noted blank sample correction was not performed. Estimated MDL is 0.1%.

Bart Huber (12)

Analyst

Approved Signatory



Bulk Asbestos Analysis

By Polarized Light Microscopy
EPA Method: 600/R-93/116 and 40 CFR, Part 763, Subpart E,
App.E



Customer: Pinchin Ltd.
6-875 Main St West
Suite 200
Hamilton, Ontario L8S 4P9

Attn: Emily Balfour
Michael Maiorana

Lab Order ID: 71918923
Analysis ID: 71918923_PLM
Date Received: 7/18/2019
Date Reported: 7/23/2019

Project: 230748,33 Cromwell Crescent, Hamilton, Ontario,Hamilton-Wentworth Catholic School Board,St. David

Sample ID	Description	Asbestos	Fibrous Components	Non-Fibrous Components	Attributes
Lab Sample ID	Lab Notes				Treatment
S0003C	Texture Finish on Wall, Chapel, Location 1016	None Detected		100% Other	White Non Fibrous Homogeneous
71918923PLM_9					Crushed
S0004A	Drywall Joint Compound on Wall, Ontario ECE Play Area, Location 1046	None Detected		100% Other	White Non Fibrous Homogeneous
71918923PLM_10					Crushed
S0004B	Drywall Joint Compound on Wall, Ontario ECE Offices, Location 1041	None Detected		100% Other	White Non Fibrous Homogeneous
71918923PLM_11					Crushed
S0004C	Drywall Joint Compound on Wall, Ontario ECE Program, Location 1040	None Detected		100% Other	White Non Fibrous Homogeneous
71918923PLM_12					Crushed

Disclaimer: Due to the nature of the EPA 600 method, asbestos may not be detected in samples containing low levels of asbestos. We strongly recommend that analysis of floor tiles, vermiculite, and/or heterogeneous soil samples be conducted by TEM for confirmation of "None Detected" by PLM. This report relates only to the samples tested and may not be reproduced, except in full, without the written approval of SAL. This report may not be used by the client to claim product endorsement by NVLAP or any other agency of the U.S. government. Analytical uncertainty available upon request. Scientific Analytical Institute participates in the NVLAP Proficiency Testing program. Unless otherwise noted blank sample correction was not performed. Estimated MDL is 0.1%.

Bart Huber (12)

Analyst

Approved Signatory

71918923
Version 1-15-2012

Client: Pinchin Ltd.
Contact: Emily Balfour
 6-875 Main Street West, Suite 200,
Address: Hamilton ON L8S 4P9
Phone: 905-577-6206
Fax: 905-577-6207
Email: ebalfour@pinchin.com
 mmaiorana@pinchin.com
 230748,33 Cromwell Crescent,
 Hamilton, Ontario, Hamilton-
 Wentworth Catholic School
Project: Board, St. David
Client Notes:
P.O. #. 230748
Date Submitted: July 17, 2019
Analysis: PLM - Stop Positive
TurnAroundTime: 4days

***Instructions:**
 Use Column "B" for your contact info

 To See an Example Click the
 bottom Example Tab.

 Enter samples between "<<" and ">>"

 Begin Samples with a "<<" above the first sample
 and end with a ">>" below the last sample.
 Only Enter your data on the first sheet "Sheet1"

 Note: Data 1 and Data 2 are optional
 fields that do not show up on the official
 report, however they will be included
 in the electronic data returned to you
 to facilitate your reintegration of the report data.

Invoice to:
 ap@pinchin.com

Scientific Analytical Institute

4604 Dundas Dr.
Greensboro, NC 27407
Phone: 336.292.3888
Fax: 336.292.3313
Email: lab@sailab.com

Sample Number	Data 1 (Lab use only)	Sample Description	Data 2 (Lab use only)
<<			
S0001A		Drywall Joint Compound on Wall, Classroom, Location 2014	
S0001B		Drywall Joint Compound on Wall, Classroom, Location 2029	
S0001C		Drywall Joint Compound on Wall, Classroom, Location 2011	
S0002A		Drywall Joint Compound on Wall, Library, Location 2020	
S0002B		Drywall Joint Compound on Wall, Computer Lab, Location 2027	
S0002C		Drywall Joint Compound on Wall, Classroom, Location 2026	
S0003A		Texture Finish on Wall, Chapel, Location 1016	
S0003B		Texture Finish on Wall, Chapel, Location 1016	
S0003C		Texture Finish on Wall, Chapel, Location 1016	
S0004A		Drywall Joint Compound on Wall, Ontario ECE Play Area, Location 1046	
S0004B		Drywall Joint Compound on Wall, Ontario ECE Offices, Location 1041	
S0004C		Drywall Joint Compound on Wall, Ontario ECE Program, Location 1040	
>>			

Accepted

Rejected

M. 110 Office
7-18 10:30 a



Pinchin Ltd. Asbestos Laboratory Certificate of Analysis

Project Name: Hamilton-Wentworth Catholic School Board, St. David,
33 Cromwell Crescent, Hamilton, Ontario

Project No.: 0272113.000

Prepared For: E. Balfour / M. Maiorana

Lab Reference No.: b230669

Analyst(s): K. Cockburn

Date Received: May 21, 2020

Date Analyzed: May 28, 2020

Samples submitted: 3

Phases analyzed: 3

Method of Analysis:

EPA 600/R-93/116 - Method for the Determination of Asbestos in Bulk Building Materials dated July, 1993

Bulk samples are checked visually and scanned under a stereomicroscope. Slides are prepared and observed under a Polarized Light Microscope (PLM) at magnifications of 40X, 100X or 400X as appropriate. Asbestos fibres are identified by a combination of morphology, colour, refractive index, extinction, sign of elongation, birefringence and dispersion staining colours. A visual estimate is made of the percentage of asbestos present. A reported concentration of less than (<) the regulatory threshold (see chart below) indicates the presence of confirmed asbestos in trace quantities, limited to only a few fibres or fibre bundles in an entire sample. This method complies with provincial regulatory requirements where applicable. Multiple phases within a sample are analyzed and reported separately.

All bulk samples submitted to this laboratory for asbestos analysis are retained for a minimum of three months. Samples may be retrieved, upon request, for re-examination at any time during that period.

The Pinchin Ltd. Mississauga asbestos laboratory is accredited by the National Institute of Standards and Technology, National Voluntary Laboratory Accreditation Program (NVLAP Lab Code 101270-0) for the 'EPA – 40 CFR Appendix E to Subpart E of Part 763, Interim Method of the Determination of Asbestos in Bulk Insulation Samples,' and the 'EPA 600/R-93/116: Method for the Determination of Asbestos in Bulk Building Materials'; and meets all requirements of ISO/IEC 17025:2005.

This report relates only to the items tested.

NOTE: *This test report may not be reproduced, except in full, without the written approval of the laboratory. The client may not use this report to claim product endorsement by NVLAP or any agency of the U.S. Government. This report is valid only when signed in blue ink by the analyst. Vinyl asbestos floor tiles contain very fine fibres of asbestos and may be missed by some laboratories using the PLM method. Internal verification studies performed by Pinchin indicate that the chance of missing asbestos in floor tiles is no higher than about 2%. The vinyl tile study and laboratory documentation on measurement uncertainty is available upon request. The analysis of dust samples by PLM cannot be used as an indicator of past or present airborne asbestos fibre levels.*



Pinchin Ltd. Asbestos Laboratory
Certificate of Analysis

Project Name: Hamilton-Wentworth Catholic School Board, St. David,
33 Cromwell Crescent, Hamilton, Ontario
Project No.: 0272113.000
Prepared For: E. Balfour / M. Maiorana
Lab Reference No.: b230669
Date Analyzed: May 28, 2020

BULK SAMPLE ANALYSIS

SAMPLE IDENTIFICATION	SAMPLE DESCRIPTION	% COMPOSITION (VISUAL ESTIMATE)	
		ASBESTOS	OTHER
S0005A Parging cement, Storage, Location 2	Homogeneous, grey, soft, parging cement.	None Detected	Cellulose 0.5-5% Man-made Vitreous 25-50% Fibres Non-Fibrous Material 50-75%
S0005B Parging cement, Storage, Location 2	Homogeneous, grey, soft, parging cement.	None Detected	Cellulose 0.5-5% Man-made Vitreous 25-50% Fibres Non-Fibrous Material 50-75%
S0005C Parging cement, Storage, Location 3	Homogeneous, grey, soft, parging cement.	None Detected	Cellulose 0.5-5% Man-made Vitreous 25-50% Fibres Non-Fibrous Material 50-75%

Reviewed by:

Reporting Analyst:



Analyzed by: AG
 Reviewed by: hb
 Report Sent by: ly

MEMBER OF
PG
 THE PINCHIN GROUP

Instructions:

Pinchin Ltd. - Asbestos Laboratory
Internal Asbestos Bulk Sample Chain of Custody

Client Name:	Hamilton-Wentworth Catholic School Board	Project Address:	33 Cromwell Crescent, Hamilton, Ontario
Portfolio/Building No:	St. David	Pinchin File:	272113
Submitted by:	Emily Balfour	Email:	ebalfour@pinchin.com
CC Results to:	Michael Maiorana	CC Email:	mmaiorana@pinchin.com
Invoice to:	Accounts Payable	Invoice Email:	ap@pinchin.com
Date Submitted:	May 19 2020	Required by:	May 26 2020
# of Samples:	3	Priority:	5 Day Turnaround
Year of Building Construction (Mandatory Field):	1971		
Do NOT Stop on Positive (Sample Numbers):			
Pinchin Group Company (Mandatory Field):	Pinchin		

To be Completed by Lab Personnel Only:			
Lab Reference #:	0230669 CA	Time:	24 hour clock
Received by:	MAY 21 2020	Date:	Month Day Year
Name(s) of Analyst(s):	AG 2020/05/28		
Sample Prefix	Sample No.	Sample Suffix	Sample Description/Location (Mandatory)
	S0005	A	Parging cement, Storage, Location 2 ND
	S0005	B	Parging cement, Storage, Location 2 ND
	S0005	C	Parging cement, Storage, Location 3 ND

APPENDIX III
Methodology

1.0 GENERAL

An inspection was conducted to identify the asbestos-containing materials (ACM) incorporated in the structure and its finishes as defined by the scope of work.

Information regarding the location and condition of ACM encountered and visually estimated quantities were recorded. The locations of any samples collected were recorded on small-scale plans. As-built drawings and previous reports were referenced where provided.

Sample collection (where performed) was conducted in accordance with our Standard Operating Procedures.

The inspection for asbestos included friable and non-friable asbestos-containing materials (ACM). A friable material is a material that when dry can be crumbled, pulverized or powdered by hand pressure.

Where samples were collected, a separate set of samples was collected of each type of homogenous material suspected to contain asbestos. A homogenous material is defined by the US EPA as material that is uniform in texture and appearance, was installed at one time, and is unlikely to consist of more than one type or formulation of material. The homogeneous materials were determined by visual examination and available information on the phases of construction and prior renovations.

Where samples were collected, samples were collected at a rate that is in compliance with the requirements of local regulations and guidelines. The sampling strategy was also based on known ban dates and phase out dates of the use of asbestos; sampling of certain building materials is not conducted after specific construction dates. In addition, to be conservative, several years past these dates are added to account for some uncertainty in the exact start / finish date of construction and associated usage of ACM. In some cases, manufactured products such as asbestos cement pipe were visually identified without sample confirmation.

Where samples were collected, the asbestos analysis was completed using a stop-positive approach. Only one result meeting the regulated criteria was required to determine that a material is asbestos-containing, but all samples must be analyzed to conclusively determine that a material is non-asbestos. The laboratory stopped analyzing samples from a homogeneous material once a result equal to or greater than the regulated criteria is detected in any of the samples of that material. All samples of a homogeneous material were analyzed if no asbestos is detected. In some cases, all samples were analyzed in the sample set regardless of result.

Where samples were collected, the analysis was performed in accordance with Test Method EPA/600/R-93/116: Method for the Determination of Asbestos in Bulk Building Materials, July 1993.

Where samples were collected, analytical results were compared to the following criteria.



Jurisdiction*	Friable	Non-Friable
Ontario	0.5%	0.5%

Where building materials are described in the report as “non-asbestos” or “does not contain asbestos”, this means that either no asbestos was detected by the analytical method utilized in any of the multiple samples or, if detected, it is below the lower limit of an asbestos-containing material in the applicable regulation. Additionally, these terms are used for materials which historically are known to not include asbestos in their manufacturing.

Asbestos materials were evaluated in order to make recommendations regarding remedial work. The priority for remedial action was based on several factors:

- Friability (friable or non-friable);
- Condition (good, fair, poor, debris);
- Accessibility (ranking from accessible to all building users to inaccessible);
- Visibility (whether the material is obscured by other building components).
- Efficiency of the work (for example, if damaged ACM is being removed in an area, it may be most practical to remove all ACM in the area even if it is in good condition).

For a complete description of the Evaluation Criteria and Basis of Recommendations, refer to Annex A.

METHODOLOGY ANNEX A EVALUATION CRITERIA

EVALUATION CRITERIA AND BASIS OF RECOMMENDATIONS

The detailed asbestos assessment provides information regarding the location, condition, accessibility and friability of the asbestos-containing materials (ACM). In order to make recommendations for compliance with current regulations, Pinchin developed the following criteria.

EVALUATION OF CONDITION

Friable Sprayed or Trowelled Fireproofing, Thermal Insulation and Texture Finishes (Surfacing Materials)

To evaluate the condition of ACM sprayed or trowelled on fireproofing, sprayed or trowelled thermal insulation (non-mechanical), or texture, decorative or acoustic finishes, the following criteria are applied:

Good	Surface of material shows no significant signs of damage, deterioration or delamination. Good condition includes unencapsulated or unpainted fireproofing or texture finishes, where no or limited delamination or damage is observed, or encapsulated fireproofing or texture finishes where the encapsulant or paint has been applied after the damage or fallout occurred.
Poor	A sprayed material that shows signs of significant damage or is significantly delaminating or deteriorating. This may be limited to surface delamination or some portion of the substrate may be exposed.

In Locations where damage exists in isolated areas, both good and poor condition may be applicable. The extent of each condition will be recorded. Fair condition is not utilized in the evaluation of ACM sprayed or trowelled fireproofing, sprayed or trowelled thermal insulation (non-mechanical), or texture, decorative or acoustic finishes.

The evaluation of the above products above ceilings may be limited by the number of observations and by building components such as ducts or full height walls that obstruct the above ceiling observations.

Friable Mechanical or Thermal System Insulation (TSI)

To evaluate the condition of mechanical insulation on vessels, boilers, breeching, ducts, pipes, fan units, equipment etc. the following criteria are applied:

Good	Insulation is completely covered in jacketing and exhibits no evidence of damage or deterioration. No insulation is exposed. Includes conditions where the jacketing has minor damage (i.e. scuffs or stains), but the jacketing is not penetrated.
Fair	Minor penetrating damage to jacketed insulation (cuts, tears, nicks, deterioration or delamination) or undamaged insulation that has never been jacketed. Insulation is exposed but not showing surface disintegration. The extent of missing insulation ranges from minor to none. Damage can be repaired.

Poor	Original insulation jacket is missing, damaged, deteriorated or delaminated. Insulation is exposed and significant areas have been dislodged. Damage cannot be readily repaired. Includes components where insulation may have been removed incompletely.
-------------	---

The evaluation of mechanical insulation may be limited by the number of observations made and building components such as ducts or full height walls that obstruct observations. It is often not possible to observe each foot of mechanical insulation from all angles.

Potentially Friable Materials and Miscellaneous Friable Materials

Potentially friable ACM are products that are basically non-friable while in place but have the potential to generate friable dust upon removal or if significantly disturbed without appropriate procedures. These products may become friable if damaged. Potentially friable materials include materials such as acoustic ceiling tiles and plaster. To evaluate the condition of potentially friable materials, the following criteria are applied:

Good	No significant damage or deterioration. Still serving its intended use as a building material or finish.
Fair	Showing signs of some cracking or breakage, but is not deteriorating (e.g. cracked plaster, broken but in place ceiling tile, missing tile or section of plaster etc.). The condition is such that it is still serving its intended use as a building material or finish but may require repair for mainly cosmetic purposes.
Poor	Significant deterioration or breaking apart of the material. Material has deteriorated to the point it is not serving its intended use as building material or finish. Material has deteriorated to a point it has become friable. Normally potentially friable ACM in Poor condition is not repairable and requires at least localized removal and replacement.

Non-Friable Materials

Non-friable ACM cover a wide range of products with a wide variation in their tendency to release dust or asbestos fibres to the air. Many of these materials, (particularly where the matrix is an unweathered bitumen, asphalt or tar material) do not release fibres except in very unusual circumstances or during significant disturbance (e.g. use of abrasive power tools). Others with a cementitious matrix (asbestos-cement products) can more readily release dust due to abrasion, demolition, weathering, etc. The potential for asbestos release from non-friable ACM is always lower than from friable ACM. To evaluate the condition of non-friable Materials, the following criteria are applied:

Good	No significant damage or deterioration. Still serving its intended use as a building material or finish.
-------------	--

Fair	Showing signs of some cracking or breakage but is not deteriorating (e.g. cracked vinyl floor tile, missing piece of tile or transite, etc.). The condition is such that it is still serving its intended use as a building material or finish but may require repair for mainly cosmetic purposes.
Poor	Significant deterioration or breaking apart of the material to the point at which it cannot be repaired, and it will require at least local removal. Material has deteriorated to the point it is not serving its intended use as building material or finish. Material may have deteriorated to a point where traffic or disturbance may cause it to become friable.

Evaluation of ACM Debris

The identification of the exact location or presence of debris on the top of ceiling tiles is limited by the number of observations made and the presence of building components such as ducts or full height walls that obstruct observations.

The presence of fallen or dislodged ACM is noted separately from the ACM source and is referred to as Debris. Debris may be friable if from a friable ACM source or a badly deteriorated non-friable ACM source. Debris may also be non-friable (such as fallen pieces of transite sheet or mastic fittings, or broken, dislodged floor tiles).

Debris	Debris may be friable or non-friable but is always identified as debris.
---------------	--

Evaluation of Presumed Asbestos-Containing Material (PACM)

Presumed asbestos-containing materials (PACM), are building materials that may contain asbestos but were not sampled or analyzed due to inaccessibility or the need to perform destructive testing to obtain a reasonable sample set. Evaluation of these materials is based on the assumption that these PACM are asbestos-containing.

A list of PACM is provided in the report and they are generally not included in the detailed room by room reports. Typically, they are excluded because they are inaccessible or present in very small quantities. If PACM are evaluated, Pinchin uses the criteria that correspond with the type (and friability) of the material listed above.

EVALUATION OF ACCESSIBILITY

The accessibility of building materials known or suspected of being ACM is rated according to the following criteria:

Access (A)	Common areas of the building within reach of all building users (approximately 8' - 9' from floor or standard ceiling height). Includes other areas where occupant activities may result in disturbance of material that is not normally within reach from floor level, but may be disturbed by common activities (e.g. gymnasiums, workshops, warehouses)
Access (B)	Areas of the building accessed primarily by Maintenance/Caretaking/Janitorial Staff and within reach without use of a ladder. Includes areas within reach in Boiler Rooms, Electrical Rooms, Janitors Closets, Elevator Rooms, Mechanical Rooms, etc. Includes materials within reach from fixed ladders or catwalks, mezzanines, and accessible pipe chases.
Access (C) and Visible	Areas of the building above 8' - 9' where use of a ladder or scaffold is required to reach the ACM. Only includes ACM that are visible to view without the removal or opening of other building components such as ceiling tiles or service access panels. Visible column on HMIS sheets will say YES.
Access (C) and not Visible	Areas of the building above 8' - 9' where use of a ladder or scaffold is required to reach the ACM. Includes ACM that are not visible to view and require the removal of a building component to see, such as ceilings tiles or access panels to view and access. Includes rarely entered crawl spaces, attic spaces, etc. Observations will be limited to the extent visible from the access points. Visible column on HMIS sheets will say NO.
Access (D)	Areas of the building behind inaccessible solid ceiling systems, walls or equipment etc. where demolition of the ceiling, wall or equipment etc. is required to reach the ACM. Material inaccessible due to height or location or is only accessed under unusual situations. Evaluation of condition and extent of ACM is limited or impossible, depending on the surveyor's ability to visually examine materials in Access D.

ACTION MATRIX AND DEFINITIONS

Pinchin's evaluation of the viability of a specific asbestos control option is based on the consideration of the friability, condition, accessibility and visibility of a material. The logic used is that damaged ACM located in an area frequently accessed by all building occupants is of a higher priority than damaged ACM located in an infrequently accessed service area. The action matrix considers the potential for fibre release (primarily from friable ACM) and the possible concerns from regulatory bodies and many building occupants to all damaged ACM (including non-friable).

In any building with asbestos, many current regulations require an Asbestos Management Program be implemented. Depending on the condition and the accessibility, more active measures such as repair or removal may be recommended. The following matrix provides guidance for recommended Actions in the absence of renovation or demolition. In the event of construction or maintenance activity which will disturb ACM more aggressive control or removal will be required.

Action Matrix

The following tables outline the action decisions based on the relationship of assessed factors. Table I applies to friable ACM. Table II applies to non-friable ACM.

Table I Decision Matrix for Friable ACM

Access	Condition			Debris
	Good	Fair	Poor	
(A)	Action 5 ¹	Action 5 ²	Action 3	Action 1
(B)	Action 7	Action 6 ³	Action 3	Action 1
(C) Visible	Action 7	Action 6	Action 3	Action 2
(C) Not Visible	Action 7	Action 7	Action 4	Action 2
(D)	Action 7	Action 7	Action 7	Action 7

Table II Decision Matrix for Potentially Friable and Non-Friable ACM

Access	Condition			Debris
	Good	Fair	Poor	
(A)	Action 7	Action 7 ⁴	Action 3	Action 1
(B)	Action 7	Action 7	Action 3	Action 1
(C) Visible	Action 7	Action 7	Action 4	Action 2
(C) Not Visible	Action 7	Action 7	Action 4	Action 2
(D)	Action 7	Action 7	Action 7	Action 7

Action Definitions

The following are the definitions in the Action Matrix Table presented above:

Action Definitions

Action 1	Clean-Up of ACM Debris Restrict access that is likely to cause a disturbance of the ACM Debris and clean up ACM Debris. Utilize appropriate asbestos precautions.
-----------------	--

¹ If friable ACM in access (A)/Good condition is not proactively removed Action 7 (Manage) is recommended.

² If friable ACM in access (A)/Fair condition is not proactively removed repair is recommended.

³ If friable ACM in access (B)/Fair condition is likely to be disturbed after repair proactive removal is recommended.

⁴ Action 7 is recommended for all non-friable ACM in Fair condition however some clients may wish to repair or take some action primarily for cosmetic reasons

Action Definitions

Action 2	<p>Precautions for Access Which may Disturb ACM Debris</p> <p>Use appropriate means to isolate the debris or to limit entry to the area which may disturb the material. At locations where ACM Debris can remain in place in lieu of removal or clean-up (e.g. Debris on top of ceiling tiles or behind lockable door), Utilize appropriate asbestos precautions to enter the area if this will disturb debris. The precautions will be required until the ACM Debris has been cleaned up.</p>
Action 3	<p>ACM Removal</p> <p>Remove ACM. Utilize asbestos procedures appropriate to the scope of the removal work. Until it is removed, restrict access to the material so it is not disturbed.</p>
Action 4	<p>Precautions for Work Which may Disturb ACM in Poor Condition. Utilize appropriate asbestos precautions if ACM may be disturbed by work on or near ACM. This does not require restricting access to the area, only control of work which may contact or disturb the ACM. Removal is the only viable option if work will disturb ACM.</p>
Action 5	<p>Proactive ACM Removal</p> <p>Remove friable ACM where the presence of friable asbestos in Good condition is not desirable. If friable ACM in Fair condition is not removed, then Repair friable ACM.</p>
Action 6	<p>ACM Repair</p> <p>Repair friable ACM in Fair condition which is not likely to be damaged again or disturbed by normal use of the area or room. Pinchin recommends proactive removal if friable ACM is likely to be damaged or disturbed during normal use of the area or room</p>
Action 7	<p>Asbestos Management Program with Routine Surveillance Implement an Asbestos Management Program, including routine surveillance of ACM. Reassess materials regularly (typically once per year).</p>

APPENDIX IV
Location List

Client: Hamilton-Wentworth Catholic District Sch
Building Name: St. David
Survey Date: 2018-08-02
Building Phases: A: 1970

Site: 33 Cromwell Cresent, Hamilton, ON
Last Re-Assessment: 2023-07-25

Location No.	Name or Description	Area ft ²	Floor No.	Bldg. Phase	Notes
0	Presumed Asbestos-Containing Materials	0	0	A	Where present, these materials are assumed to contain asbestos until otherwise proven by sampling and analysis.
1	Storage, room no. B110	0	B	A	
2	Storage, room no. B109	0	B	A	
3	Storage, room no. B108	0	B	A	
4	Storage, room no. B107	0	B	A	
5	Stairwell, room no. B005	0	B	A	
6	Stairwell, room no. B006	0	B	A	
7	Electrical, room no. B007	0	B	A	
8	Sprinkler Room, room no. B008	0	B	A	
9	Alarm Control Room, room no. B009	0	B	A	
10	Sink Room, room no. B010	0	B	A	
11	Classroom B105, room no. B105	0	B	A	
12	Classroom B106, room no. B106	0	B	A	
13	Corridor, room no. B013	0	B	A	
1001	Kindergarten	0	1	A	
1002	Cafeteria Foyer	0	1	A	
1003	Stairwell	0	1	A	
1004	Sick Room	0	1	A	
1005	Office	0	1	A	
1006	Principal	0	1	A	
1007	Staff Room	0	1	A	
1008	Vice Principal	0	1	A	
1009	Copy Room	0	1	A	
1010	Washroom	0	1	A	
1011	Womens Washroom	0	1	A	
1012	Corridor	0	1	A	
1013	Storage	0	1	A	
1014	Classroom, room no. 117	0	1	A	
1015	Classroom, room no. 118	0	1	A	
1016	Chapel	0	1	A	
1017	Corridor	0	1	A	
1019	Classroom, room no. 123	0	1	A	
1020	Classroom, room no. 122	0	1	A	
1021	Cafeteria	0	1	A	
1022	Custodian	0	1	A	
1023	School Council	0	1	A	
1024	Girls Washroom	0	1	A	
1025	Boys Washroom	0	1	A	
1026	Storage	0	1	A	
1027	Stage Storage	0	1	A	
1028	Stage Storage	0	1	A	
1029	Stage Storage	0	1	A	
1030	Stage Storage	0	1	A	
1031	Storage	0	1	A	
1032	Storage (Former Shower)	0	1	A	
1033	Storage	0	1	A	
1034	Storage	0	1	A	
1035	French Office	0	1	A	
1036	Mens Washroom	0	1	A	
1037	Gym Storage	0	1	A	
1038	Storage	0	1	A	
1039	Corridor	0	1	A	
1040	Ontario ECE Program	0	1	A	NO ACCESS
1041	Ontario ECE Offices	0	1	A	
1042	Ontario ECE Daycare Washroom	0	1	A	
1043	Ontario ECE Centre	0	1	A	
1044	Ontario ECE Quiet Room	0	1	A	

Location No.	Name or Description	Area ft ²	Floor No.	Bldg. Phase	Notes
1045	Ontario ECE Storage	0	1	A	
1046	Ontario ECE Play Area	0	1	A	
1047	Abandoned Stairwell	0	1	A	
1048	Storage	0	1	A	
1049	Former Shower Room	0	1	A	
2001	Electrical Room	0	2	A	
2002	Staff Washroom	0	2	A	
2003	Staff Washroom	0	2	A	
2004	Corridor	0	2	A	
2005	Classroom, room no. 213	0	2	A	
2006	Classroom, room no. 218	0	2	A	
2007	Classroom, room no. 211	0	2	A	
2008	Book Room	0	2	A	
2009	Hot Water Room	0	2	A	
2010	Classroom, room no. 208	0	2	A	
2011	Classroom, room no. 207	0	2	A	
2012	Classroom, room no. 206	0	2	A	
2013	Classroom, room no. 205	0	2	A	
2014	Classroom, room no. 204	0	2	A	
2015	LRT Room	0	2	A	
2016	Server Room	0	2	A	
2017	Classroom, room no. 201	0	2	A	
2018	Corridor	0	2	A	
2019	Corridor	0	2	A	
2020	Library	0	2	A	
2021	Office	0	2	A	
2022	Reading Recovery	0	2	A	
2023	Girls Washroom	0	2	A	
2024	Boys Washroom	0	2	A	
2025	Classroom, room no. 224	0	2	A	
2026	Classroom, room no. 223	0	2	A	
2027	Computer Lab	0	2	A	
2028	Classroom, room no. 220	0	2	A	
2029	Classroom, room no. 219	0	2	A	
2030	Classroom, room no. 218	0	2	A	
2031	Classroom, room no. 217	0	2	A	

APPENDIX V
Summary Report / Sample Log

Client: Hamilton-Wentworth Catholic District Sch

Site: 33 Cromwell Cresnet, Hamilton, ON

Building Name: St. David

Survey Date: 2018-08-02

HAZMAT	Sample No	System/Component/Material/Sample Description	Locations	Bldg. Phase	LF	SF	EA	%	Type	Positive	Friability
Asbestos	S0001 ABC	Wall Drywall And Joint Compound	2010,2011,2012,2013,2014,2028,2029,2030,2031	A	0	0	0	100	None Detected	No	
Asbestos	S0002 ABC	Wall Drywall And Joint Compound	2018,2019,2020,2021,2022,2025,2026,2027	A	0	0	0	100	None Detected	No	
Asbestos	S0003 ABC	Wall Texture Coat	1016	A	0	0	0	100	None Detected	No	
Asbestos	S0004 ABC	Wall, Ceiling, Wall Drywall And Joint Compound	1039,1040,1041,1042,1043,1044,1045,1046	A	0	0	0	100	None Detected	No	
Asbestos	S0005 ABC	Piping Parging Cement	2,3,13,1037,2009	A	0	0	25	0	None Detected	No	
Asbestos	V9500	Floor Mastic	9,1004,1005,1007,1019,1020,1040,1044,2004,2006 2012,2013,2014,2015,2016,2017,2018,2019,2021 2022,2026,2027,2028	A	0	0	0	100	Presumed Asbestos	Yes	NF
Asbestos	V9500	Other N/a Roofing Felts And Tar, Mastics, Floor Levelling Compound, Ceramic Tile Setting Compound, Elevator And Lift Brakes, Electrical Components, Mechanical Packing, Ropes And Gaskets, Vermiculite, Adhesives And Duct Mastics, Caulking And Putties, Fibre-reinforced Paints And Coatings, Paper Products, Soffit And Fascia Boards, Fire Resistant Doors, Stucco, Plaster Or Other Cementitious Parge Coatings, Vibration Dampers On Hvac Equipment, Terrazzo, Ropes And Gaskets In Cast-iron Bell And Spigot Joints, Sealants On Pipe Threads	0	A	0	0	0	100	Presumed Asbestos	Yes	NF
Asbestos	V0000	Ceiling Acoustic Tile Ceiling Tiles (lay-in) Short Fissure And Random Pinhole	1043,2007,2008,2021,2028,2029	A	0	0	0	100	Non Asbestos	No	
Asbestos	V0000	Ceiling Acoustic Tile Ceiling Tiles (lay-in) Short Fissure And Random Pinhole	6,1001,1002,1003,1004,1012,1013,1014,1015,1016 1020,1021,1022,1039,1040,1041,1044,1045,2001 2004,2005,2006,2009,2011,2012,2013,2014,2015 2016,2017,2019,2020,2022,2025,2026,2027,2030 2031	A	0	0	0	100	Non Asbestos	No	
Asbestos	V0000	Ceiling Acoustic Tile Ceiling Tiles (lay-in) Short Fissure With Ransom Pinhole	1046	A	0	0	0	100	Non Asbestos	No	
Asbestos	V0000	Ceiling Acoustic Tile Ceiling Tiles (lay-in) Small Irregular Pinhole	2025	A	0	0	0	100	Non Asbestos	No	
Asbestos	V0000	Ceiling Acoustic Tile Ceiling Tiles (lay-in) Small And Irregular Pinhole	1005,1006,1007,1008,1009,1019,1035,2010,2011 2013,2014,2026	A	0	0	0	100	Non Asbestos	No	
Asbestos	V0000	Ceiling Plaster	5,6,1003,1010,1011,1017,1023,1024,1025,1031 1032,1033,1034,1036,1038,1047,1048,1049,2002 2003,2023,2024	A	0	0	0	100	Non Asbestos	No	

HAZMAT	Sample No	System/Component/Material/Sample Description	Locations	Bldg. Phase	LF	SF	EA	%	Type	Positive	Friability
Asbestos	V0000	Floor Rubber Vinyl Plank (wood Look)	1040	A	0	0	0	0	Non Asbestos	No	
Asbestos	V0000	Floor Rubber Vinyl Plank (wood Look)	1044	A	0	0	0	0	Non Asbestos	No	
Asbestos	V0000	Floor Vinyl Floor Tile Beige Multi-fleck	9,1004,1005,1007,1019,1020,2004,2006,2012,2013 2014,2016,2017,2018,2019,2021,2022,2026,2027 2028	A	0	0	0	100	Non Asbestos	No	
Asbestos	V0000	Floor Vinyl Floor Tile Beige And Multi-fleck	2015	A	0	0	0	100	Non Asbestos	No	
Asbestos	V0000	Floor Vinyl Floor Tile And Mastic 12x12 Light Green Multi-fleck	6	A	0	0	0	100	Non Asbestos	No	
Asbestos	V0000	Floor Vinyl Floor Tile And Mastic Green Multi-fleck	11,12,1001,1009,1012,1013,1014,1015,1021,1022 1026,1027,1028,1029,1030,1031,1033,1034,1035 1038,1039,1041,1042,1043,1045,1046,1047,1048	A	0	0	0	100	Non Asbestos	No	
Asbestos	V0000	Floor Vinyl Floor Tile And Mastic Light Green Multi-fleck	11,12,1001,1012,1013,1014,1015,1021,1022,1026 1027,1028,1029,1030,1033,1034,1035,1038,1041 1042,1043,1045,1046,1047,1048,2004,2005,2006 2007,2008,2010,2011,2012,2015,2016,2025,2028 2029,2030,2031	A	0	0	0	100	Non Asbestos	No	
Asbestos	V0000	Floor Vinyl Floor Tile And Mastic Light Green And Multi-fleck	1009,1031,1039	A	0	0	0	100	Non Asbestos	No	
Asbestos	V0000	Wall Plaster	1006,1012,1013,1014,1015,1021,1022,1023	A	0	0	0	100	Non Asbestos	No	

Legend:

Sample number		Units		
S####	Asbestos sample collected	SF	Square feet	NF Non Friable material.
L####	Paint sample collected	LF	Linear feet	F Friable material
P####	PCB sample collected	EA	Each	PF Potentially Friable material
M####	Mould sample collected	%	Percentage	
V####	Material visually similar to numbered sample collected			
V0000	Known non Hazardous Material			
V9000	Material is visually identified as Hazardous Material			
V9500	Material is presumed to be Hazardous Material			
[Loc. No.]	Abated Material			

APPENDIX VI
HMIS All Data Report

Client: Hamilton-Wentworth Catholic District Sch
Location: #0 : Presumed Asbestos-Containing Materials
Survey Date: 2018-08-02

Site: Elementary
Floor: 0

Building Name: St. David
Room #:
Last Re-Assessment: 2023-07-25

Area (sqft): 0

ASBESTOS																
System	Component	Material	Item	Covering	A*	V*	AP*	Good	Fair	Poor	Unit	Sample	Asbestos Type	Amount	Hazard	Friable
Other		N/A, Roofing felts and tar, mastics, Floor levelling compound, Ceramic tile setting compound, Elevator and Lift Brakes, Electrical components, Mechanical packing, ropes and gaskets, Vermiculite, Adhesives and duct mastics, Caulking and putties, Fibre-reinforced paints and coatings, Paper products, Soffit and fascia boards, Fire resistant doors, Stucco, plaster or other cementitious parge coatings, Vibration dampers on HVAC equipment, Terrazzo, Ropes and gaskets in cast-iron bell and spigot joints, Sealants on pipe threads			D	N		100(7)			%	V9500	Presumed Asbestos		Presumed Asbestos	NF

Where present, these materials are assumed to contain asbestos until otherwise proven by sampling and analysis.

Client: Hamilton-Wentworth Catholic District Sch
Location: #1 : Storage
Survey Date: 2018-08-02

Site: Elementary
Floor: B

Building Name: St. David
Room #: B110
Last Re-Assessment: 2023-07-25

Area (sqft): 0

ASBESTOS																
System	Component	Material	Item	Covering	A*	V*	AP*	Good	Fair	Poor	Unit	Sample	Asbestos Type	Amount	Hazard	Friable
Floor		Concrete (poured)			A	Y										
Piping ¹		Fibreglass			C	Y										
Structure	Deck	Concrete (poured)			C	Y										
Wall ²		Masonry			A	Y										

- 1 - Above Ceiling
- 2 - Concrete Block

Client: Hamilton-Wentworth Catholic District Sch
Location: #2 : Storage
Survey Date: 2018-08-02

Site: Elementary
Floor: B

Building Name: St. David
Room #: B109
Last Re-Assessment: 2023-07-25

Area (sqft): 0

ASBESTOS																
System	Component	Material	Item	Covering	A*	V*	AP*	Good	Fair	Poor	Unit	Sample	Asbestos Type	Amount	Hazard	Friable
Floor		Concrete (poured)			A	Y										
Piping ¹		Fibreglass			C	Y										
Piping ²		Parging Cement	Fitting		C	Y		2			EA	S0005AB	None Detected	N.D.	None	
Structure	Deck	Concrete (poured)			C	Y										
Wall ³		Masonry			A	Y										

- 1 - Above Ceiling
- 2 - Ceiling Level
- 3 - Concrete Block

Client: Hamilton-Wentworth Catholic District Sch
Location: #3 : Storage
Survey Date: 2018-08-02

Site: Elementary
Floor: B

Building Name: St. David
Room #: B108
Last Re-Assessment: 2023-07-25

Area (sqft): 0

ASBESTOS																
System	Component	Material	Item	Covering	A*	V*	AP*	Good	Fair	Poor	Unit	Sample	Asbestos Type	Amount	Hazard	Friable
Floor		Concrete (poured)			A	Y										
Piping ¹		Fibreglass			C	Y										
Piping ²		Parging Cement	Fitting		C	Y		2			EA	S0005C	None Detected	N.D.	None	
Structure	Deck	Concrete (poured)			C	Y										
Wall ³		Masonry			A	Y										

- 1 - Above Ceiling
- 2 - Ceiling Level
- 3 - Concrete Block

Client: Hamilton-Wentworth Catholic District Sch
Location: #4 : Storage
Survey Date: 2018-08-02

Site: Elementary
Floor: B

Building Name: St. David
Room #: B107
Last Re-Assessment: 2023-07-25

Area (sqft): 0

ASBESTOS																
System	Component	Material	Item	Covering	A*	V*	AP*	Good	Fair	Poor	Unit	Sample	Asbestos Type	Amount	Hazard	Friable
Floor		Concrete (poured)			A	Y										
Structure	Deck	Concrete (poured)			C	Y										
Wall ¹		Masonry			A	Y										

1 - Concrete Block

Client: Hamilton-Wentworth Catholic District Sch
Location: #5 : Stairwell
Survey Date: 2018-08-02

Site: Elementary
Floor: B

Building Name: St. David
Room #: B005
Last Re-Assessment: 2023-07-25

Area (sqft): 0

ASBESTOS																
System	Component	Material	Item	Covering	A*	V*	AP*	Good	Fair	Poor	Unit	Sample	Asbestos Type	Amount	Hazard	Friable
Ceiling		Plaster			C	Y		100			%	V0000	Non-Asbestos		None	
Floor		Ceramic Tiles			A	Y										
Wall ¹		Masonry			A	Y										

1 - Concrete Block

Client: Hamilton-Wentworth Catholic District Sch
Location: #6 : Stairwell
Survey Date: 2018-08-02

Site: Elementary
Floor: B

Building Name: St. David
Room #: B006
Last Re-Assessment: 2023-07-25

Area (sqft): 0

ASBESTOS																
System	Component	Material	Item	Covering	A*	V*	AP*	Good	Fair	Poor	Unit	Sample	Asbestos Type	Amount	Hazard	Friable
Ceiling		Plaster			C	Y		100			%	V0000	Non-Asbestos		None	
Ceiling	Acoustic Tile	Ceiling Tiles (lay-in), Short Fissure and Random Pinhole			C	Y		100			%	V0000	Non-Asbestos		None	
Floor		Vinyl Floor Tile and Mastic, 12x12 light green multi-fleck			A	Y		100			%	V0000	Non-Asbestos		None	
Floor		Ceramic Tiles			A	Y										
Wall ¹		Masonry			A	Y										

1 - Concrete Block

Client: Hamilton-Wentworth Catholic District Sch
Location: #7 : Electrical
Survey Date: 2018-08-02

Site: Elementary
Floor: B

Building Name: St. David
Room #: B007
Last Re-Assessment: 2023-07-25

Area (sqft): 0

ASBESTOS																
System	Component	Material	Item	Covering	A*	V*	AP*	Good	Fair	Poor	Unit	Sample	Asbestos Type	Amount	Hazard	Friable
Floor		Concrete (poured)			A	Y										
Structure	Deck	Concrete (poured)			C	Y										
Wall ¹		Masonry			A	Y										

1 - Concrete Block

Client: Hamilton-Wentworth Catholic District Sch
Location: #8 : Sprinkler Room
Survey Date: 2018-08-02

Site: Elementary
Floor: B

Building Name: St. David
Room #: B008
Last Re-Assessment: 2023-07-25

Area (sqft): 0

ASBESTOS																
System	Component	Material	Item	Covering	A*	V*	AP*	Good	Fair	Poor	Unit	Sample	Asbestos Type	Amount	Hazard	Friable
Floor		Concrete (poured)			A	Y										
Structure	Deck	Concrete (poured)			C	Y										
Wall ¹		Masonry			A	Y										

1 - Concrete Block

Client: Hamilton-Wentworth Catholic District Sch
Location: #9 : Alarm Control Room
Survey Date: 2018-08-02

Site: Elementary
Floor: B

Building Name: St. David
Room #: B009
Last Re-Assessment: 2023-07-25

Area (sqft): 0

ASBESTOS																
System	Component	Material	Item	Covering	A*	V*	AP*	Good	Fair	Poor	Unit	Sample	Asbestos Type	Amount	Hazard	Friable
Floor		Mastic		Vinyl Floor Tile	D	N		100(7)			%	V9500	Presumed Asbestos		Presumed Asbestos	NF
Floor		Vinyl Floor Tile, Beige Multi-Fleck			A	Y		100			%	V0000	Non-Asbestos		None	
Structure	Deck	Concrete (poured)			C	Y										
Wall ¹		Masonry			A	Y										

1 - Concrete Block

Client: Hamilton-Wentworth Catholic District Sch
Location: #10 : Sink Room
Survey Date: 2018-08-02

Site: Elementary
Floor: B

Building Name: St. David
Room #: B010
Last Re-Assessment: 2023-07-25

Area (sqft): 0

ASBESTOS																
System	Component	Material	Item	Covering	A*	V*	AP*	Good	Fair	Poor	Unit	Sample	Asbestos Type	Amount	Hazard	Friable
Floor		Concrete (poured)			A	Y										
Piping ¹		Fibreglass			C	Y										
Structure	Deck	Concrete (poured)			C	Y										
Wall ²		Masonry			A	Y										

- 1 - Above Ceiling
- 2 - Concrete Block

Client: Hamilton-Wentworth Catholic District Sch
Location: #11 : Classroom B105
Survey Date: 2018-08-02

Site: Elementary
Floor: B

Building Name: St. David
Room #: B105
Last Re-Assessment: 2023-07-25

Area (sqft): 0

ASBESTOS																
System	Component	Material	Item	Covering	A*	V*	AP*	Good	Fair	Poor	Unit	Sample	Asbestos Type	Amount	Hazard	Friable
Floor		Vinyl Floor Tile and Mastic, Light Green Multi-Fleck			A	Y		100			%	V0000	Non-Asbestos		None	
Floor		Vinyl Floor Tile and Mastic, Green Multi-Fleck			A	Y		100			%	V0000	Non-Asbestos		None	
Structure	Deck	Concrete (poured)			C	Y										
Wall ¹		Masonry			A	Y										

- 1 - Concrete Block

Client: Hamilton-Wentworth Catholic District Sch
Location: #12 : Classroom B106
Survey Date: 2018-08-02

Site: Elementary
Floor: B

Building Name: St. David
Room #: B106
Last Re-Assessment: 2023-07-25

Area (sqft): 0

ASBESTOS																
System	Component	Material	Item	Covering	A*	V*	AP*	Good	Fair	Poor	Unit	Sample	Asbestos Type	Amount	Hazard	Friable
Floor		Vinyl Floor Tile and Mastic, Light Green Multi-Fleck			A	Y		100			%	V0000	Non-Asbestos		None	
Floor		Vinyl Floor Tile and Mastic, Green Multi-Fleck			A	Y		100			%	V0000	Non-Asbestos		None	
Structure	Deck	Concrete (poured)			C	Y										
Wall ¹		Masonry			A	Y										

1 - Concrete Block

Client: Hamilton-Wentworth Catholic District Sch
Location: #13 : Corridor
Survey Date: 2018-08-02

Site: Elementary
Floor: B

Building Name: St. David
Room #: B013
Last Re-Assessment: 2023-07-25

Area (sqft): 0

ASBESTOS																
System	Component	Material	Item	Covering	A*	V*	AP*	Good	Fair	Poor	Unit	Sample	Asbestos Type	Amount	Hazard	Friable
Floor		Ceramic Tiles			A	Y										
Piping ¹		Fibreglass			C	Y										
Piping ²		Parging Cement			C	Y		14			EA	V0005	None Detected	N.D.	None	
Structure	Deck	Concrete (poured)			C	Y										
Wall ³		Masonry			A	Y										

1 - Above Ceiling
2 - Ceiling Level
3 - Concrete Block

Client: Hamilton-Wentworth Catholic District Sch
Location: #1001 : Kindergarten
Survey Date: 2018-08-02

Site: Elementary
Floor: 1

Building Name: St. David
Room #:
Last Re-Assessment: 2023-07-25

Area (sqft): 0

ASBESTOS																
System	Component	Material	Item	Covering	A*	V*	AP*	Good	Fair	Poor	Unit	Sample	Asbestos Type	Amount	Hazard	Friable
Ceiling	Acoustic Tile	Ceiling Tiles (lay-in), Short Fissure and Random Pinhole			C	Y		100			%	V0000	Non-Asbestos		None	
Floor		Vinyl Floor Tile and Mastic, Light Green Multi-Fleck			A	Y		100			%	V0000	Non-Asbestos		None	
Floor		Vinyl Floor Tile and Mastic, Green Multi-Fleck			A	Y		100			%	V0000	Non-Asbestos		None	
Piping ¹		Fibreglass			C	Y										
Wall ²		Masonry			A	Y										

- 1 - Above Ceiling
- 2 - Concrete Block

Client: Hamilton-Wentworth Catholic District Sch
Location: #1002 : Cafeteria Foyer
Survey Date: 2018-08-02

Site: Elementary
Floor: 1

Building Name: St. David
Room #:
Last Re-Assessment: 2023-07-25

Area (sqft): 0

ASBESTOS																
System	Component	Material	Item	Covering	A*	V*	AP*	Good	Fair	Poor	Unit	Sample	Asbestos Type	Amount	Hazard	Friable
Ceiling	Acoustic Tile	Ceiling Tiles (lay-in), Short Fissure and Random Pinhole			C	Y		100			%	V0000	Non-Asbestos		None	
Floor		Ceramic Tiles			A	Y										
Piping ¹		Fibreglass			C	Y										
Wall ²		Masonry			A	Y										

- 1 - Above Ceiling
- 2 - Concrete Block

Client: Hamilton-Wentworth Catholic District Sch
Location: #1003 : Stairwell
Survey Date: 2018-08-02

Site: Elementary
Floor: 1

Building Name: St. David
Room #:
Last Re-Assessment: 2023-07-25

Area (sqft): 0

ASBESTOS																
System	Component	Material	Item	Covering	A*	V*	AP*	Good	Fair	Poor	Unit	Sample	Asbestos Type	Amount	Hazard	Friable
Ceiling ¹		Plaster			C	Y		100			%	V0000	Non-Asbestos		None	
Ceiling	Acoustic Tile	Ceiling Tiles (lay-in), Short Fissure and Random Pinhole			C	Y		100			%	V0000	Non-Asbestos		None	
Floor		Ceramic Tiles			A	Y										
Piping ²		Fibreglass			C	Y										
Wall ³		Masonry			A	Y										

- 1 - Hard Textured Plaster
- 2 - Above Ceiling
- 3 - Concrete Block

Client: Hamilton-Wentworth Catholic District Sch
Location: #1004 : Sick Room
Survey Date: 2018-08-02

Site: Elementary
Floor: 1

Building Name: St. David
Room #:
Last Re-Assessment: 2023-07-25

Area (sqft): 0

ASBESTOS																
System	Component	Material	Item	Covering	A*	V*	AP*	Good	Fair	Poor	Unit	Sample	Asbestos Type	Amount	Hazard	Friable
Ceiling	Acoustic Tile	Ceiling Tiles (lay-in), Short Fissure and Random Pinhole			C	Y		100			%	V0000	Non-Asbestos		None	
Floor		Mastic		Vinyl Floor Tile	D	N		100(7)			%	V9500	Presumed Asbestos		Presumed Asbestos	NF
Floor		Vinyl Floor Tile, Beige Multi-Fleck			A	Y		100			%	V0000	Non-Asbestos		None	
Piping ¹		Fibreglass			C	Y										
Wall ²		Masonry			A	Y										

- 1 - Above Ceiling
- 2 - Concrete Block

Client: Hamilton-Wentworth Catholic District Sch
Location: #1005 : Office
Survey Date: 2018-08-02

Site: Elementary
Floor: 1

Building Name: St. David
Room #:
Last Re-Assessment: 2023-07-25

Area (sqft): 0

ASBESTOS																
System	Component	Material	Item	Covering	A*	V*	AP*	Good	Fair	Poor	Unit	Sample	Asbestos Type	Amount	Hazard	Friable
Ceiling	Acoustic Tile	Ceiling Tiles (lay-in), Small and Irregular Pinhole			C	Y		100			%	V0000	Non-Asbestos		None	
Floor		Carpet			A	Y										
Floor		Mastic		Vinyl Floor Tile	D	N		100(7)			%	V9500	Presumed Asbestos		Presumed Asbestos	NF
Floor		Vinyl Floor Tile, Beige Multi-Fleck			A	Y		100			%	V0000	Non-Asbestos		None	
Wall ¹		Masonry			A	Y										

1 - Concrete Block

Client: Hamilton-Wentworth Catholic District Sch
Location: #1006 : Principal
Survey Date: 2018-08-02

Site: Elementary
Floor: 1

Building Name: St. David
Room #:
Last Re-Assessment: 2023-07-25

Area (sqft): 0

ASBESTOS																
System	Component	Material	Item	Covering	A*	V*	AP*	Good	Fair	Poor	Unit	Sample	Asbestos Type	Amount	Hazard	Friable
Ceiling	Acoustic Tile	Ceiling Tiles (lay-in), Small and Irregular Pinhole			C	Y		100			%	V0000	Non-Asbestos		None	
Floor		Carpet			A	Y										
Wall		Plaster			A	Y		100			%	V0000	Non-Asbestos		None	
Wall ¹		Masonry			A	Y										

1 - Concrete Block

Client: Hamilton-Wentworth Catholic District Sch
Location: #1007 : Staff Room
Survey Date: 2018-08-02

Site: Elementary
Floor: 1

Building Name: St. David
Room #:
Last Re-Assessment: 2023-07-25

Area (sqft): 0

ASBESTOS																
System	Component	Material	Item	Covering	A*	V*	AP*	Good	Fair	Poor	Unit	Sample	Asbestos Type	Amount	Hazard	Friable
Ceiling	Acoustic Tile	Ceiling Tiles (lay-in), Small and Irregular Pinhole			C	Y		100			%	V0000	Non-Asbestos		None	
Floor		Mastic		Vinyl Floor Tile	D	N		100(7)			%	V9500	Presumed Asbestos		Presumed Asbestos	NF
Floor		Vinyl Floor Tile, Beige Multi-Fleck			A	Y		100			%	V0000	Non-Asbestos		None	
Wall ¹		Masonry			A	Y										

1 - Concrete Block

Client: Hamilton-Wentworth Catholic District Sch
Location: #1008 : Vice Principal
Survey Date: 2018-08-02

Site: Elementary
Floor: 1

Building Name: St. David
Room #:
Last Re-Assessment: 2023-07-25

Area (sqft): 0

ASBESTOS																
System	Component	Material	Item	Covering	A*	V*	AP*	Good	Fair	Poor	Unit	Sample	Asbestos Type	Amount	Hazard	Friable
Ceiling	Acoustic Tile	Ceiling Tiles (lay-in), Small and Irregular Pinhole			C	Y		100			%	V0000	Non-Asbestos		None	
Floor		Carpet			A	Y										
Wall ¹		Masonry			A	Y										

1 - Concrete Block

Client: Hamilton-Wentworth Catholic District Sch
Location: #1009 : Copy Room
Survey Date: 2018-08-02

Site: Elementary
Floor: 1

Building Name: St. David
Room #:
Last Re-Assessment: 2023-07-25

Area (sqft): 0

ASBESTOS																
System	Component	Material	Item	Covering	A*	V*	AP*	Good	Fair	Poor	Unit	Sample	Asbestos Type	Amount	Hazard	Friable
Ceiling	Acoustic Tile	Ceiling Tiles (lay-in), Small and Irregular Pinhole			C	Y		100			%	V0000	Non-Asbestos		None	
Floor		Vinyl Floor Tile and Mastic, Light Green and Multi-Fleck			A	Y		100			%	V0000	Non-Asbestos		None	
Floor		Vinyl Floor Tile and Mastic, Green Multi-Fleck			A	Y		100			%	V0000	Non-Asbestos		None	
Wall ¹		Masonry			A	Y										

1 - Concrete Block

Client: Hamilton-Wentworth Catholic District Sch
Location: #1010 : Washroom
Survey Date: 2018-08-02

Site: Elementary
Floor: 1

Building Name: St. David
Room #:
Last Re-Assessment: 2023-07-25

Area (sqft): 0

ASBESTOS																
System	Component	Material	Item	Covering	A*	V*	AP*	Good	Fair	Poor	Unit	Sample	Asbestos Type	Amount	Hazard	Friable
Ceiling		Plaster			C	Y		100			%	V0000	Non-Asbestos		None	
Floor		Ceramic Tiles			A	Y										
Wall ¹		Masonry			A	Y										

1 - Concrete Block

Client: Hamilton-Wentworth Catholic District Sch
Location: #1011 : Womens Washroom
Survey Date: 2018-08-02

Site: Elementary
Floor: 1

Building Name: St. David
Room #:
Last Re-Assessment: 2023-07-25

Area (sqft): 0

ASBESTOS																
System	Component	Material	Item	Covering	A*	V*	AP*	Good	Fair	Poor	Unit	Sample	Asbestos Type	Amount	Hazard	Friable
Ceiling		Plaster			C	Y		100			%	V0000	Non-Asbestos		None	
Floor		Ceramic Tiles			A	Y										
Wall ¹		Masonry			A	Y										

1 - Concrete Block

Client: Hamilton-Wentworth Catholic District Sch
Location: #1012 : Corridor
Survey Date: 2018-08-02

Site: Elementary
Floor: 1

Building Name: St. David
Room #:
Last Re-Assessment: 2023-07-25

Area (sqft): 0

ASBESTOS																
System	Component	Material	Item	Covering	A*	V*	AP*	Good	Fair	Poor	Unit	Sample	Asbestos Type	Amount	Hazard	Friable
Ceiling	Acoustic Tile	Ceiling Tiles (lay-in), Short Fissure and Random Pinhole			C	Y		100			%	V0000	Non-Asbestos		None	
Floor		Vinyl Floor Tile and Mastic, Light Green Multi-Fleck			A	Y		100			%	V0000	Non-Asbestos		None	
Floor		Vinyl Floor Tile and Mastic, Green Multi-Fleck			A	Y		100			%	V0000	Non-Asbestos		None	
Wall		Plaster			A	Y		100			%	V0000	Non-Asbestos		None	
Wall ¹		Masonry			A	Y										

1 - Concrete Block

Client: Hamilton-Wentworth Catholic District Sch
Location: #1013 : Storage
Survey Date: 2018-08-02

Site: Elementary
Floor: 1

Building Name: St. David
Room #:
Last Re-Assessment: 2023-07-25

Area (sqft): 0

ASBESTOS																
System	Component	Material	Item	Covering	A*	V*	AP*	Good	Fair	Poor	Unit	Sample	Asbestos Type	Amount	Hazard	Friable
Ceiling	Acoustic Tile	Ceiling Tiles (lay-in), Short Fissure and Random Pinhole			C	Y		100			%	V0000	Non-Asbestos		None	
Floor		Vinyl Floor Tile and Mastic, Light Green Multi-Fleck			A	Y		100			%	V0000	Non-Asbestos		None	
Floor		Vinyl Floor Tile and Mastic, Green Multi-Fleck			A	Y		100			%	V0000	Non-Asbestos		None	
Wall		Plaster			A	Y		100			%	V0000	Non-Asbestos		None	
Wall ¹		Masonry			A	Y										

1 - Concrete Block

Client: Hamilton-Wentworth Catholic District Sch
Location: #1014 : Classroom
Survey Date: 2018-08-02

Site: Elementary
Floor: 1

Building Name: St. David
Room #: 117
Last Re-Assessment: 2023-07-25

Area (sqft): 0

ASBESTOS																
System	Component	Material	Item	Covering	A*	V*	AP*	Good	Fair	Poor	Unit	Sample	Asbestos Type	Amount	Hazard	Friable
Ceiling	Acoustic Tile	Ceiling Tiles (lay-in), Short Fissure and Random Pinhole			C	Y		100			%	V0000	Non-Asbestos		None	
Floor		Vinyl Floor Tile and Mastic, Light Green Multi-Fleck			A	Y		100			%	V0000	Non-Asbestos		None	
Floor		Vinyl Floor Tile and Mastic, Green Multi-Fleck			A	Y		100			%	V0000	Non-Asbestos		None	
Wall		Plaster			A	Y		100			%	V0000	Non-Asbestos		None	
Wall ¹		Masonry			A	Y										

1 - Concrete Block

Client: Hamilton-Wentworth Catholic District Sch
Location: #1015 : Classroom
Survey Date: 2018-08-02

Site: Elementary
Floor: 1

Building Name: St. David
Room #: 118
Last Re-Assessment: 2023-07-25

Area (sqft): 0

ASBESTOS																
System	Component	Material	Item	Covering	A*	V*	AP*	Good	Fair	Poor	Unit	Sample	Asbestos Type	Amount	Hazard	Friable
Ceiling	Acoustic Tile	Ceiling Tiles (lay-in), Short Fissure and Random Pinhole			C	Y		100			%	V0000	Non-Asbestos		None	
Floor		Vinyl Floor Tile and Mastic, Light Green Multi-Fleck			A	Y		100			%	V0000	Non-Asbestos		None	
Floor		Vinyl Floor Tile and Mastic, Green Multi-Fleck			A	Y		100			%	V0000	Non-Asbestos		None	
Wall		Plaster			A	Y		100			%	V0000	Non-Asbestos		None	
Wall ¹		Masonry			A	Y										

1 - Concrete Block

Client: Hamilton-Wentworth Catholic District Sch
Location: #1016 : Chapel
Survey Date: 2018-08-02

Site: Elementary
Floor: 1

Building Name: St. David
Room #:
Last Re-Assessment: 2023-07-25

Area (sqft): 0

ASBESTOS																
System	Component	Material	Item	Covering	A*	V*	AP*	Good	Fair	Poor	Unit	Sample	Asbestos Type	Amount	Hazard	Friable
Ceiling	Acoustic Tile	Ceiling Tiles (lay-in), Short Fissure and Random Pinhole			C	Y		100			%	V0000	Non-Asbestos		None	
Floor		Carpet			A	Y										
Wall ¹		Masonry			A	Y										
Wall		Texture Coat			A	Y		100			%	S0003ABC	None Detected	N.D.	None	

1 - Faux Brick

Client: Hamilton-Wentworth Catholic District Sch
Location: #1017 : Corridor
Survey Date: 2018-08-02

Site: Elementary
Floor: 1

Building Name: St. David
Room #:
Last Re-Assessment: 2023-07-25

Area (sqft): 0

ASBESTOS																
System	Component	Material	Item	Covering	A*	V*	AP*	Good	Fair	Poor	Unit	Sample	Asbestos Type	Amount	Hazard	Friable
Ceiling		Plaster			C	Y		100			%	V0000	Non-Asbestos		None	
Floor		Ceramic Tiles			A	Y										
Wall ¹		Masonry			A	Y										

1 - Concrete Block

Client: Hamilton-Wentworth Catholic District Sch
Location: #1019 : Classroom
Survey Date: 2018-08-02

Site: Elementary
Floor: 1

Building Name: St. David
Room #: 123
Last Re-Assessment: 2023-07-25

Area (sqft): 0

ASBESTOS																
System	Component	Material	Item	Covering	A*	V*	AP*	Good	Fair	Poor	Unit	Sample	Asbestos Type	Amount	Hazard	Friable
Ceiling	Acoustic Tile	Ceiling Tiles (lay-in), Small and Irregular Pinhole			C	Y		100			%	V0000	Non-Asbestos		None	
Floor		Mastic		Vinyl Floor Tile	D	N		100(7)			%	V9500	Presumed Asbestos		Presumed Asbestos	NF
Floor		Vinyl Floor Tile, Beige Multi-Fleck			A	Y		100			%	V0000	Non-Asbestos		None	
Wall ¹		Masonry			A	Y										

1 - Concrete Block

Client: Hamilton-Wentworth Catholic District Sch
Location: #1020 : Classroom
Survey Date: 2018-08-02

Site: Elementary
Floor: 1

Building Name: St. David
Room #: 122
Last Re-Assessment: 2023-07-25

Area (sqft): 0

ASBESTOS																
System	Component	Material	Item	Covering	A*	V*	AP*	Good	Fair	Poor	Unit	Sample	Asbestos Type	Amount	Hazard	Friable
Ceiling	Acoustic Tile	Ceiling Tiles (lay-in), Short Fissure and Random Pinhole			C	Y		100			%	V0000	Non-Asbestos		None	
Floor		Mastic		Vinyl Floor Tile	D	N		100(7)			%	V9500	Presumed Asbestos		Presumed Asbestos	NF
Floor		Vinyl Floor Tile, Beige Multi-Fleck			A	Y		100			%	V0000	Non-Asbestos		None	
Wall ¹		Masonry			A	Y										

1 - Concrete Block

Client: Hamilton-Wentworth Catholic District Sch
Location: #1021 : Cafeteria
Survey Date: 2018-08-02

Site: Elementary
Floor: 1

Building Name: St. David
Room #:
Last Re-Assessment: 2023-07-25

Area (sqft): 0

ASBESTOS																
System	Component	Material	Item	Covering	A*	V*	AP*	Good	Fair	Poor	Unit	Sample	Asbestos Type	Amount	Hazard	Friable
Ceiling	Acoustic Tile	Ceiling Tiles (lay-in), Short Fissure and Random Pinhole			C	Y		100			%	V0000	Non-Asbestos		None	
Floor		Vinyl Floor Tile and Mastic, Light Green Multi-Fleck			A	Y		100			%	V0000	Non-Asbestos		None	
Floor		Vinyl Floor Tile and Mastic, Green Multi-Fleck			A	Y		100			%	V0000	Non-Asbestos		None	
Wall		Plaster			A	Y		100			%	V0000	Non-Asbestos		None	
Wall ¹		Masonry			A	Y										

1 - Concrete Block

Client: Hamilton-Wentworth Catholic District Sch
Location: #1022 : Custodian
Survey Date: 2018-08-02

Site: Elementary
Floor: 1

Building Name: St. David
Room #:
Last Re-Assessment: 2023-07-25

Area (sqft): 0

ASBESTOS																
System	Component	Material	Item	Covering	A*	V*	AP*	Good	Fair	Poor	Unit	Sample	Asbestos Type	Amount	Hazard	Friable
Ceiling	Acoustic Tile	Ceiling Tiles (lay-in), Short Fissure and Random Pinhole			C	Y		100			%	V0000	Non-Asbestos		None	
Floor		Vinyl Floor Tile and Mastic, Light Green Multi-Fleck			A	Y		100			%	V0000	Non-Asbestos		None	
Floor		Vinyl Floor Tile and Mastic, Green Multi-Fleck			A	Y		100			%	V0000	Non-Asbestos		None	
Wall		Plaster			A	Y		100			%	V0000	Non-Asbestos		None	
Wall ¹		Masonry			A	Y										

1 - Concrete Block

Client: Hamilton-Wentworth Catholic District Sch
Location: #1023 : School Council
Survey Date: 2018-08-02

Site: Elementary
Floor: 1

Building Name: St. David
Room #:
Last Re-Assessment: 2023-07-25

Area (sqft): 0

ASBESTOS																
System	Component	Material	Item	Covering	A*	V*	AP*	Good	Fair	Poor	Unit	Sample	Asbestos Type	Amount	Hazard	Friable
Ceiling		Plaster			C	Y		100			%	V0000	Non-Asbestos		None	
Floor		Ceramic Tiles			A	Y										
Piping ¹		Fibreglass			C	Y										
Wall		Plaster			A	Y		100			%	V0000	Non-Asbestos		None	

1 - Above Ceiling

Client: Hamilton-Wentworth Catholic District Sch
Location: #1024 : Girls Washroom
Survey Date: 2018-08-02

Site: Elementary
Floor: 1

Building Name: St. David
Room #:
Last Re-Assessment: 2023-07-25

Area (sqft): 0

ASBESTOS																
System	Component	Material	Item	Covering	A*	V*	AP*	Good	Fair	Poor	Unit	Sample	Asbestos Type	Amount	Hazard	Friable
Ceiling		Plaster			C	Y		100			%	V0000	Non-Asbestos		None	
Floor		Ceramic Tiles			A	Y										
Wall ¹		Masonry			A	Y										

1 - Concrete Block

Client: Hamilton-Wentworth Catholic District Sch
Location: #1025 : Boys Washroom
Survey Date: 2018-08-02

Site: Elementary
Floor: 1

Building Name: St. David
Room #:
Last Re-Assessment: 2023-07-25

Area (sqft): 0

ASBESTOS																
System	Component	Material	Item	Covering	A*	V*	AP*	Good	Fair	Poor	Unit	Sample	Asbestos Type	Amount	Hazard	Friable
Ceiling		Plaster			C	Y		100			%	V0000	Non-Asbestos		None	
Floor		Ceramic Tiles			A	Y										
Wall ¹		Masonry			A	Y										

1 - Concrete Block

Client: Hamilton-Wentworth Catholic District Sch
Location: #1026 : Storage
Survey Date: 2018-08-02

Site: Elementary
Floor: 1

Building Name: St. David
Room #:
Last Re-Assessment: 2023-07-25

Area (sqft): 0

ASBESTOS																
System	Component	Material	Item	Covering	A*	V*	AP*	Good	Fair	Poor	Unit	Sample	Asbestos Type	Amount	Hazard	Friable
Floor		Vinyl Floor Tile and Mastic, Light Green Multi-Fleck			A	Y		100			%	V0000	Non-Asbestos		None	
Floor		Vinyl Floor Tile and Mastic, Green Multi-Fleck			A	Y		100			%	V0000	Non-Asbestos		None	
Structure	Deck	Steel			C	Y										
Wall ¹		Masonry			A	Y										

1 - Concrete Block

Client: Hamilton-Wentworth Catholic District Sch
Location: #1027 : Stage Storage
Survey Date: 2018-08-02

Site: Elementary
Floor: 1

Building Name: St. David
Room #:
Last Re-Assessment: 2023-07-25

Area (sqft): 0

ASBESTOS																
System	Component	Material	Item	Covering	A*	V*	AP*	Good	Fair	Poor	Unit	Sample	Asbestos Type	Amount	Hazard	Friable
Floor		Vinyl Floor Tile and Mastic, Light Green Multi-Fleck			A	Y		100			%	V0000	Non-Asbestos		None	
Floor		Vinyl Floor Tile and Mastic, Green Multi-Fleck			A	Y		100			%	V0000	Non-Asbestos		None	
Structure	Deck	Steel			C	Y										
Wall ¹		Masonry			A	Y										

1 - Concrete Block

Client: Hamilton-Wentworth Catholic District Sch
Location: #1028 : Stage STORAGE
Survey Date: 2018-08-02

Site: Elementary
Floor: 1

Building Name: St. David
Room #:
Last Re-Assessment: 2023-07-25

Area (sqft): 0

ASBESTOS																
System	Component	Material	Item	Covering	A*	V*	AP*	Good	Fair	Poor	Unit	Sample	Asbestos Type	Amount	Hazard	Friable
Floor		Vinyl Floor Tile and Mastic, Light Green Multi-Fleck			A	Y		100			%	V0000	Non-Asbestos		None	
Floor		Vinyl Floor Tile and Mastic, Green Multi-Fleck			A	Y		100			%	V0000	Non-Asbestos		None	
Structure	Deck	Steel			C	Y										
Wall ¹		Masonry			A	Y										

1 - Concrete Block

Client: Hamilton-Wentworth Catholic District Sch
Location: #1029 : Stage Storage
Survey Date: 2018-08-02

Site: Elementary
Floor: 1

Building Name: St. David
Room #:
Last Re-Assessment: 2023-07-25

Area (sqft): 0

ASBESTOS																
System	Component	Material	Item	Covering	A*	V*	AP*	Good	Fair	Poor	Unit	Sample	Asbestos Type	Amount	Hazard	Friable
Floor		Vinyl Floor Tile and Mastic, Light Green Multi-Fleck			A	Y		100			%	V0000	Non-Asbestos		None	
Floor		Vinyl Floor Tile and Mastic, Green Multi-Fleck			A	Y		100			%	V0000	Non-Asbestos		None	
Structure	Deck	Steel			C	Y										
Wall ¹		Masonry			A	Y										

1 - Concrete Block

Client: Hamilton-Wentworth Catholic District Sch
Location: #1030 : Stage Storage
Survey Date: 2018-08-02

Site: Elementary
Floor: 1

Building Name: St. David
Room #:
Last Re-Assessment: 2023-07-25

Area (sqft): 0

ASBESTOS																
System	Component	Material	Item	Covering	A*	V*	AP*	Good	Fair	Poor	Unit	Sample	Asbestos Type	Amount	Hazard	Friable
Floor		Vinyl Floor Tile and Mastic, Light Green Multi-Fleck			A	Y		100			%	V0000	Non-Asbestos		None	
Floor		Vinyl Floor Tile and Mastic, Green Multi-Fleck			A	Y		100			%	V0000	Non-Asbestos		None	
Structure	Deck	Steel			C	Y										
Wall ¹		Masonry			A	Y										

1 - Concrete Block

Client: Hamilton-Wentworth Catholic District Sch
Location: #1031 : Storage
Survey Date: 2018-08-02

Site: Elementary
Floor: 1

Building Name: St. David
Room #:
Last Re-Assessment: 2023-07-25

Area (sqft): 0

ASBESTOS																
System	Component	Material	Item	Covering	A*	V*	AP*	Good	Fair	Poor	Unit	Sample	Asbestos Type	Amount	Hazard	Friable
Ceiling		Plaster			C	Y		100			%	V0000	Non-Asbestos		None	
Floor		Vinyl Floor Tile and Mastic, Light Green and Multi-Fleck			A	Y		100			%	V0000	Non-Asbestos		None	
Floor		Vinyl Floor Tile and Mastic, Green Multi-Fleck			A	Y		100			%	V0000	Non-Asbestos		None	
Wall ¹		Masonry			A	Y										

1 - Concrete Block

Client: Hamilton-Wentworth Catholic District Sch
Location: #1032 : Storage (Former Shower)
Survey Date: 2018-08-02

Site: Elementary
Floor: 1

Building Name: St. David
Room #:
Last Re-Assessment: 2023-07-25

Area (sqft): 0

ASBESTOS																
System	Component	Material	Item	Covering	A*	V*	AP*	Good	Fair	Poor	Unit	Sample	Asbestos Type	Amount	Hazard	Friable
Ceiling ¹		Plaster			C	Y		100			%	V0000	Non-Asbestos		None	
Floor		Ceramic Tiles			A	Y										
Wall ²		Masonry			A	Y										
Wall		Ceramic Tiles			A	Y										

1 - Hard Textured Plaster
2 - Concrete Block

Client: Hamilton-Wentworth Catholic District Sch
Location: #1033 : Storage
Survey Date: 2018-08-02

Site: Elementary
Floor: 1

Building Name: St. David
Room #:
Last Re-Assessment: 2023-07-25

Area (sqft): 0

ASBESTOS																
System	Component	Material	Item	Covering	A*	V*	AP*	Good	Fair	Poor	Unit	Sample	Asbestos Type	Amount	Hazard	Friable
Ceiling		Plaster			C	Y		100			%	V0000	Non-Asbestos		None	
Floor		Vinyl Floor Tile and Mastic, Light Green Multi-Fleck			A	Y		100			%	V0000	Non-Asbestos		None	
Floor		Vinyl Floor Tile and Mastic, Green Multi-Fleck			A	Y		100			%	V0000	Non-Asbestos		None	
Wall ¹		Masonry			A	Y										

1 - Concrete Block

Client: Hamilton-Wentworth Catholic District Sch
Location: #1034 : Storage
Survey Date: 2018-08-02

Site: Elementary
Floor: 1

Building Name: St. David
Room #:
Last Re-Assessment: 2023-07-25

Area (sqft): 0

ASBESTOS																
System	Component	Material	Item	Covering	A*	V*	AP*	Good	Fair	Poor	Unit	Sample	Asbestos Type	Amount	Hazard	Friable
Ceiling		Plaster			C	Y		100			%	V0000	Non-Asbestos		None	
Floor		Vinyl Floor Tile and Mastic, Light Green Multi-Fleck			A	Y		100			%	V0000	Non-Asbestos		None	
Floor		Vinyl Floor Tile and Mastic, Green Multi-Fleck			A	Y		100			%	V0000	Non-Asbestos		None	
Wall ¹		Masonry			A	Y										

1 - Concrete Block

Client: Hamilton-Wentworth Catholic District Sch
Location: #1035 : French Office
Survey Date: 2018-08-02

Site: Elementary
Floor: 1

Building Name: St. David
Room #:
Last Re-Assessment: 2023-07-25

Area (sqft): 0

ASBESTOS																
System	Component	Material	Item	Covering	A*	V*	AP*	Good	Fair	Poor	Unit	Sample	Asbestos Type	Amount	Hazard	Friable
Ceiling	Acoustic Tile	Ceiling Tiles (lay-in), Small and Irregular Pinhole			C	Y		100			%	V0000	Non-Asbestos		None	
Floor		Vinyl Floor Tile and Mastic, Light Green Multi-Fleck			A	Y		100			%	V0000	Non-Asbestos		None	
Floor		Vinyl Floor Tile and Mastic, Green Multi-Fleck			A	Y		100			%	V0000	Non-Asbestos		None	
Wall ¹		Masonry			A	Y										

1 - Concrete Block

Client: Hamilton-Wentworth Catholic District Sch
Location: #1036 : Mens Washroom
Survey Date: 2018-08-02

Site: Elementary
Floor: 1

Building Name: St. David
Room #:
Last Re-Assessment: 2023-07-25

Area (sqft): 0

ASBESTOS																
System	Component	Material	Item	Covering	A*	V*	AP*	Good	Fair	Poor	Unit	Sample	Asbestos Type	Amount	Hazard	Friable
Ceiling		Plaster			C	Y		100			%	V0000	Non-Asbestos		None	
Floor		Ceramic Tiles			A	Y										
Wall ¹		Masonry			A	Y										

1 - Concrete Block

Client: Hamilton-Wentworth Catholic District Sch
Location: #1037 : Gym Storage
Survey Date: 2018-08-02

Site: Elementary
Floor: 1

Building Name: St. David
Room #:
Last Re-Assessment: 2023-07-25

Area (sqft): 0

ASBESTOS																
System	Component	Material	Item	Covering	A*	V*	AP*	Good	Fair	Poor	Unit	Sample	Asbestos Type	Amount	Hazard	Friable
Floor		Concrete (poured)			A	Y										
Piping ¹		Fibreglass			C	Y										
Piping		Parging Cement	Fitting		C	Y		4			EA	V0005	None Detected	N.D.	None	
Structure	Deck	Steel			C	Y										
Wall ²		Masonry			A	Y										

1 - Above Ceiling

2 - Concrete Block

Client: Hamilton-Wentworth Catholic District Sch
Location: #1038 : Storage
Survey Date: 2018-08-02

Site: Elementary
Floor: 1

Building Name: St. David
Room #:
Last Re-Assessment: 2023-07-25

Area (sqft): 0

ASBESTOS																
System	Component	Material	Item	Covering	A*	V*	AP*	Good	Fair	Poor	Unit	Sample	Asbestos Type	Amount	Hazard	Friable
Ceiling		Plaster			C	Y		100			%	V0000	Non-Asbestos		None	
Floor		Vinyl Floor Tile and Mastic, Light Green Multi-Fleck			A	Y		100			%	V0000	Non-Asbestos		None	
Floor		Vinyl Floor Tile and Mastic, Green Multi-Fleck			A	Y		100			%	V0000	Non-Asbestos		None	
Wall ¹		Masonry			A	Y										

1 - Concrete Block

Client: Hamilton-Wentworth Catholic District Sch
Location: #1039 : Corridor
Survey Date: 2018-08-02

Site: Elementary
Floor: 1

Building Name: St. David
Room #:
Last Re-Assessment: 2023-07-25

Area (sqft): 0

ASBESTOS																
System	Component	Material	Item	Covering	A*	V*	AP*	Good	Fair	Poor	Unit	Sample	Asbestos Type	Amount	Hazard	Friable
Ceiling		Drywall and joint compound			C	Y						V0004	None Detected	N.D.	None	
Ceiling	Acoustic Tile	Ceiling Tiles (lay-in), Short Fissure and Random Pinhole			C	Y		100			%	V0000	Non-Asbestos		None	
Floor		Vinyl Floor Tile and Mastic, Light Green and Multi-Fleck			A	Y		100			%	V0000	Non-Asbestos		None	
Floor		Vinyl Floor Tile and Mastic, Green Multi-Fleck			A	Y		100			%	V0000	Non-Asbestos		None	
Wall		Drywall and joint compound			A	Y		100			%	V0004	None Detected	N.D.	None	
Wall ¹		Masonry			A	Y										

1 - Concrete Block

Client: Hamilton-Wentworth Catholic District Sch
Location: #1040 : Ontario ECE Program
Survey Date: 2018-08-02

Site: Elementary
Floor: 1

Building Name: St. David
Room #:
Last Re-Assessment: 2023-07-25

Area (sqft): 0

ASBESTOS - NO ACCESS																
System	Component	Material	Item	Covering	A*	V*	AP*	Good	Fair	Poor	Unit	Sample	Asbestos Type	Amount	Hazard	Friable
Ceiling		Drywall and joint compound			C	Y		100			%	V0004	None Detected	N.D.	None	
Ceiling	Acoustic Tile	Ceiling Tiles (lay-in), Short Fissure and Random Pinhole			C	Y		100			%	V0000	Non-Asbestos		None	
Floor		Rubber, Vinyl plank (wood look)			A	Y						V0000	Non-Asbestos		None	
Floor		Mastic		Rubber	D	N		100(7)			%	V9500	Presumed Asbestos		Presumed Asbestos	NF
Piping ¹		Fibreglass			C	Y										
Wall		Drywall and joint compound			A	Y		100			%	S0004C	None Detected	N.D.	None	
Wall ²		Masonry			A	Y										

1 - Above Ceiling
2 - Concrete Block

Client: Hamilton-Wentworth Catholic District Sch
Location: #1041 : Ontario ECE Offices
Survey Date: 2018-08-02

Site: Elementary
Floor: 1

Building Name: St. David
Room #:
Last Re-Assessment: 2023-07-25

Area (sqft): 0

ASBESTOS																
System	Component	Material	Item	Covering	A*	V*	AP*	Good	Fair	Poor	Unit	Sample	Asbestos Type	Amount	Hazard	Friable
Ceiling	Acoustic Tile	Ceiling Tiles (lay-in), Short Fissure and Random Pinhole			C	Y		100			%	V0000	Non-Asbestos		None	
Floor		Vinyl Floor Tile and Mastic, Green Multi-Fleck			A	Y		100			%	V0000	Non-Asbestos		None	
Floor		Vinyl Floor Tile and Mastic, Light Green Multi-Fleck			A	Y		100			%	V0000	Non-Asbestos		None	
Wall		Drywall and joint compound			A	Y		100			%	S0004B	None Detected	N.D.	None	
Wall ¹		Masonry			A	Y										

1 - Concrete Block

Client: Hamilton-Wentworth Catholic District Sch **Site:** Elementary
Location: #1042 : Ontario ECE Daycare **Floor:** 1
Washroom
Survey Date: 2018-08-02

Building Name: St. David
Room #: **Area (sqft):** 0
Last Re-Assessment: 2023-07-25

ASBESTOS																
System	Component	Material	Item	Covering	A*	V*	AP*	Good	Fair	Poor	Unit	Sample	Asbestos Type	Amount	Hazard	Friable
Ceiling		Drywall and joint compound			C	Y		100			%	V0004	None Detected	N.D.	None	
Floor		Vinyl Floor Tile and Mastic, Green Multi-Fleck			A	Y		100			%	V0000	Non-Asbestos		None	
Floor		Vinyl Floor Tile and Mastic, Light Green Multi-Fleck			A	Y		100			%	V0000	Non-Asbestos		None	
Wall		Drywall and joint compound			A	Y		100			%	V0004	None Detected	N.D.	None	
Wall ¹		Masonry			A	Y										

1 - Concrete Block

Client: Hamilton-Wentworth Catholic District Sch **Site:** Elementary
Location: #1043 : Ontario ECE Centre **Floor:** 1
Survey Date: 2018-08-02

Building Name: St. David
Room #: **Area (sqft):** 0
Last Re-Assessment: 2023-07-25

ASBESTOS																
System	Component	Material	Item	Covering	A*	V*	AP*	Good	Fair	Poor	Unit	Sample	Asbestos Type	Amount	Hazard	Friable
Ceiling	Acoustic Tile	Ceiling Tiles (lay-in), Short Fissure and Random Pinhole			C	Y		100			%	V0000	Non-Asbestos		None	
Floor		Vinyl Floor Tile and Mastic, Green Multi-Fleck			A	Y		100			%	V0000	Non-Asbestos		None	
Floor		Vinyl Floor Tile and Mastic, Light Green Multi-Fleck			A	Y		100			%	V0000	Non-Asbestos		None	
Wall		Drywall and joint compound			A	Y		100			%	V0004	None Detected	N.D.	None	
Wall ¹		Masonry			A	Y										

1 - Concrete Block

Client: Hamilton-Wentworth Catholic District Sch
Location: #1044 : Ontario ECE Quiet Room
Survey Date: 2018-08-02

Site: Elementary
Floor: 1

Building Name: St. David
Room #:
Last Re-Assessment: 2023-07-25

Area (sqft): 0

ASBESTOS																
System	Component	Material	Item	Covering	A*	V*	AP*	Good	Fair	Poor	Unit	Sample	Asbestos Type	Amount	Hazard	Friable
Ceiling	Acoustic Tile	Ceiling Tiles (lay-in), Short Fissure and Random Pinhole			C	Y		100			%	V0000	Non-Asbestos		None	
Floor		Rubber, vinyl plank (wood look)			A	Y						V0000	Non-Asbestos		None	
Floor		Mastic		Rubber	D	N		100(7)			%	V9500	Presumed Asbestos		Presumed Asbestos	NF
Wall		Drywall and joint compound			A	Y		100			%	V0004	None Detected	N.D.	None	
Wall ¹		Masonry			A	Y										

1 - Concrete Block

Client: Hamilton-Wentworth Catholic District Sch
Location: #1045 : Ontario ECE Storage
Survey Date: 2018-08-02

Site: Elementary
Floor: 1

Building Name: St. David
Room #:
Last Re-Assessment: 2023-07-25

Area (sqft): 0

ASBESTOS																
System	Component	Material	Item	Covering	A*	V*	AP*	Good	Fair	Poor	Unit	Sample	Asbestos Type	Amount	Hazard	Friable
Ceiling	Acoustic Tile	Ceiling Tiles (lay-in), Short Fissure and Random Pinhole			C	Y		100			%	V0000	Non-Asbestos		None	
Floor		Vinyl Floor Tile and Mastic, Green Multi-Fleck			A	Y		100			%	V0000	Non-Asbestos		None	
Floor		Vinyl Floor Tile and Mastic, Light Green Multi-Fleck			A	Y		100			%	V0000	Non-Asbestos		None	
Wall		Drywall and joint compound			A	Y		100			%	V0004	None Detected	N.D.	None	

Client: Hamilton-Wentworth Catholic District Sch
Location: #1046 : Ontario ECE Play Area
Survey Date: 2018-08-02

Site: Elementary
Floor: 1

Building Name: St. David
Room #:
Last Re-Assessment: 2023-07-25

Area (sqft): 0

ASBESTOS																
System	Component	Material	Item	Covering	A*	V*	AP*	Good	Fair	Poor	Unit	Sample	Asbestos Type	Amount	Hazard	Friable
Ceiling	Acoustic Tile	Ceiling Tiles (lay-in), Short Fissure with Ransom Pinhole			C	Y		100			%	V0000	Non-Asbestos		None	
Floor		Vinyl Floor Tile and Mastic, Green Multi-Fleck			A	Y		100			%	V0000	Non-Asbestos		None	
Floor		Vinyl Floor Tile and Mastic, Light Green Multi-Fleck			A	Y		100			%	V0000	Non-Asbestos		None	
Wall		Drywall and joint compound			A	Y		100			%	S0004A	None Detected	N.D.	None	
Wall ¹		Masonry			A	Y										

1 - Concrete Block

Client: Hamilton-Wentworth Catholic District Sch
Location: #1047 : Abandoned Stairwell
Survey Date: 2018-08-02

Site: Elementary
Floor: 1

Building Name: St. David
Room #:
Last Re-Assessment: 2023-07-25

Area (sqft): 0

ASBESTOS																
System	Component	Material	Item	Covering	A*	V*	AP*	Good	Fair	Poor	Unit	Sample	Asbestos Type	Amount	Hazard	Friable
Ceiling		Plaster			C	Y		100			%	V0000	Non-Asbestos		None	
Floor		Vinyl Floor Tile and Mastic, Green Multi-Fleck			A	Y		100			%	V0000	Non-Asbestos		None	
Floor		Vinyl Floor Tile and Mastic, Light Green Multi-Fleck			A	Y		100			%	V0000	Non-Asbestos		None	
Wall ¹		Masonry			A	Y										

1 - Concrete Block

Client: Hamilton-Wentworth Catholic District Sch
Location: #1048 : Storage
Survey Date: 2018-08-02

Site: Elementary
Floor: 1

Building Name: St. David
Room #:
Last Re-Assessment: 2023-07-25

Area (sqft): 0

ASBESTOS																
System	Component	Material	Item	Covering	A*	V*	AP*	Good	Fair	Poor	Unit	Sample	Asbestos Type	Amount	Hazard	Friable
Ceiling		Plaster			C	Y		100			%	V0000	Non-Asbestos		None	
Floor		Vinyl Floor Tile and Mastic, Green Multi-Fleck			A	Y		100			%	V0000	Non-Asbestos		None	
Floor		Vinyl Floor Tile and Mastic, Light Green Multi-Fleck			A	Y		100			%	V0000	Non-Asbestos		None	
Wall ¹		Masonry			A	Y										

1 - Concrete Block

Client: Hamilton-Wentworth Catholic District Sch
Location: #1049 : Former Shower Room
Survey Date: 2018-08-02

Site: Elementary
Floor: 1

Building Name: St. David
Room #:
Last Re-Assessment: 2023-07-25

Area (sqft): 0

ASBESTOS																
System	Component	Material	Item	Covering	A*	V*	AP*	Good	Fair	Poor	Unit	Sample	Asbestos Type	Amount	Hazard	Friable
Ceiling ¹		Plaster			C	Y		100			%	V0000	Non-Asbestos		None	
Floor		Ceramic Tiles			A	Y										
Wall ²		Masonry			A	Y										

1 - Hard Textured Plaster
2 - Concrete Block

Client: Hamilton-Wentworth Catholic District Sch
Location: #2001 : Electrical Room
Survey Date: 2018-08-02

Site: Elementary
Floor: 2

Building Name: St. David
Room #:
Last Re-Assessment: 2023-07-25

Area (sqft): 0

ASBESTOS																
System	Component	Material	Item	Covering	A*	V*	AP*	Good	Fair	Poor	Unit	Sample	Asbestos Type	Amount	Hazard	Friable
Ceiling	Acoustic Tile	Ceiling Tiles (lay-in), Short Fissure and Random Pinhole			C	Y		100			%	V0000	Non-Asbestos		None	
Floor		Concrete (poured)			A	Y										
Wall ¹		Masonry			A	Y										

1 - Concrete Block

Client: Hamilton-Wentworth Catholic District Sch
Location: #2002 : Staff Washroom
Survey Date: 2018-08-02

Site: Elementary
Floor: 2

Building Name: St. David
Room #:
Last Re-Assessment: 2023-07-25

Area (sqft): 0

ASBESTOS																
System	Component	Material	Item	Covering	A*	V*	AP*	Good	Fair	Poor	Unit	Sample	Asbestos Type	Amount	Hazard	Friable
Ceiling		Plaster			C	Y		100			%	V0000	Non-Asbestos		None	
Floor		Ceramic Tiles			A	Y										
Wall ¹		Masonry			A	Y										

1 - Concrete Block

Client: Hamilton-Wentworth Catholic District Sch
Location: #2003 : Staff Washroom
Survey Date: 2018-08-02

Site: Elementary
Floor: 2

Building Name: St. David
Room #:
Last Re-Assessment: 2023-07-25

Area (sqft): 0

ASBESTOS																
System	Component	Material	Item	Covering	A*	V*	AP*	Good	Fair	Poor	Unit	Sample	Asbestos Type	Amount	Hazard	Friable
Ceiling		Plaster			C	Y		100			%	V0000	Non-Asbestos		None	
Floor		Ceramic Tiles			A	Y										
Wall ¹		Masonry			A	Y										

1 - Concrete Block

Client: Hamilton-Wentworth Catholic District Sch
Location: #2004 : Corridor
Survey Date: 2018-08-02

Site: Elementary
Floor: 2

Building Name: St. David
Room #:
Last Re-Assessment: 2023-07-25

Area (sqft): 0

ASBESTOS																
System	Component	Material	Item	Covering	A*	V*	AP*	Good	Fair	Poor	Unit	Sample	Asbestos Type	Amount	Hazard	Friable
Ceiling	Acoustic Tile	Ceiling Tiles (lay-in), Short Fissure and Random Pinhole			C	Y		100			%	V0000	Non-Asbestos		None	
Floor		Vinyl Floor Tile and Mastic, Light Green Multi-Fleck			A	Y		100			%	V0000	Non-Asbestos		None	
Floor		Mastic		Vinyl Floor Tile	D	N		100(7)			%	V9500	Presumed Asbestos		Presumed Asbestos	NF
Floor		Vinyl Floor Tile, Beige Multi-Fleck			A	Y		100			%	V0000	Non-Asbestos		None	
Wall ¹		Masonry			A	Y										

1 - Concrete Block

Client: Hamilton-Wentworth Catholic District Sch
Location: #2005 : Classroom
Survey Date: 2018-08-02

Site: Elementary
Floor: 2

Building Name: St. David
Room #: 213
Last Re-Assessment: 2023-07-25

Area (sqft): 0

ASBESTOS																
System	Component	Material	Item	Covering	A*	V*	AP*	Good	Fair	Poor	Unit	Sample	Asbestos Type	Amount	Hazard	Friable
Ceiling	Acoustic Tile	Ceiling Tiles (lay-in), Short Fissure and Random Pinhole			C	Y		100			%	V0000	Non-Asbestos		None	
Floor		Vinyl Floor Tile and Mastic, Light Green Multi-Fleck			A	Y		100			%	V0000	Non-Asbestos		None	
Wall ¹		Masonry			A	Y										

1 - Concrete Block

Client: Hamilton-Wentworth Catholic District Sch
Location: #2006 : Classroom
Survey Date: 2018-08-02

Site: Elementary
Floor: 2

Building Name: St. David
Room #: 218
Last Re-Assessment: 2023-07-25

Area (sqft): 0

ASBESTOS																
System	Component	Material	Item	Covering	A*	V*	AP*	Good	Fair	Poor	Unit	Sample	Asbestos Type	Amount	Hazard	Friable
Ceiling	Acoustic Tile	Ceiling Tiles (lay-in), Short Fissure and Random Pinhole			C	Y		100			%	V0000	Non-Asbestos		None	
Floor		Vinyl Floor Tile and Mastic, Light Green Multi-Fleck			A	Y		100			%	V0000	Non-Asbestos		None	
Floor		Mastic		Vinyl Floor Tile	D	N		100(7)			%	V9500	Presumed Asbestos		Presumed Asbestos	NF
Floor		Vinyl Floor Tile, Beige Multi-Fleck			A	Y		100			%	V0000	Non-Asbestos		None	
Wall ¹		Masonry			A	Y										

1 - Concrete Block

Client: Hamilton-Wentworth Catholic District Sch
Location: #2007 : Classroom
Survey Date: 2018-08-02

Site: Elementary
Floor: 2

Building Name: St. David
Room #: 211
Last Re-Assessment: 2023-07-25

Area (sqft): 0

ASBESTOS																
System	Component	Material	Item	Covering	A*	V*	AP*	Good	Fair	Poor	Unit	Sample	Asbestos Type	Amount	Hazard	Friable
Ceiling	Acoustic Tile	Ceiling Tiles (lay-in), Short Fissure and Random Pinhole			C	Y		100			%	V0000	Non-Asbestos		None	
Floor		Vinyl Floor Tile and Mastic, Light Green Multi-Fleck			A	Y		100			%	V0000	Non-Asbestos		None	
Wall ¹		Masonry			A	Y										

1 - Concrete Block

Client: Hamilton-Wentworth Catholic District Sch
Location: #2008 : Book Room
Survey Date: 2018-08-02

Site: Elementary
Floor: 2

Building Name: St. David
Room #:
Last Re-Assessment: 2023-07-25

Area (sqft): 0

ASBESTOS																
System	Component	Material	Item	Covering	A*	V*	AP*	Good	Fair	Poor	Unit	Sample	Asbestos Type	Amount	Hazard	Friable
Ceiling	Acoustic Tile	Ceiling Tiles (lay-in), Short Fissure and Random Pinhole			C	Y		100			%	V0000	Non-Asbestos		None	
Floor		Vinyl Floor Tile and Mastic, Light Green Multi-Fleck			A	Y		100			%	V0000	Non-Asbestos		None	
Wall ¹		Masonry			A	Y										

1 - Concrete Block

Client: Hamilton-Wentworth Catholic District Sch
Location: #2009 : Hot Water Room
Survey Date: 2018-08-02

Site: Elementary
Floor: 2

Building Name: St. David
Room #:
Last Re-Assessment: 2023-07-25

Area (sqft): 0

ASBESTOS																
System	Component	Material	Item	Covering	A*	V*	AP*	Good	Fair	Poor	Unit	Sample	Asbestos Type	Amount	Hazard	Friable
Ceiling	Acoustic Tile	Ceiling Tiles (lay-in), Short Fissure and Random Pinhole			C	Y		100			%	V0000	Non-Asbestos		None	
Floor		Concrete (poured)			A	Y										
Piping		Fibreglass			C	Y										
Piping		Parging Cement	Fitting		C	Y		3			EA	V0005	None Detected	N.D.	None	
Wall ¹		Masonry			A	Y										

1 - Concrete Block

Client: Hamilton-Wentworth Catholic District Sch
Location: #2010 : Classroom
Survey Date: 2018-08-02

Site: Elementary
Floor: 2

Building Name: St. David
Room #: 208
Last Re-Assessment: 2023-07-25

Area (sqft): 0

ASBESTOS																
System	Component	Material	Item	Covering	A*	V*	AP*	Good	Fair	Poor	Unit	Sample	Asbestos Type	Amount	Hazard	Friable
Ceiling	Acoustic Tile	Ceiling Tiles (lay-in), Small and Irregular Pinhole			C	Y		100			%	V0000	Non-Asbestos		None	
Floor		Vinyl Floor Tile and Mastic, Light Green Multi-Fleck			A	Y		100			%	V0000	Non-Asbestos		None	
Wall		Drywall and joint compound			A	Y		100			%	V0001	None Detected	N.D.	None	
Wall ¹		Masonry			A	Y										

1 - Concrete Block

Client: Hamilton-Wentworth Catholic District Sch
Location: #2011 : Classroom
Survey Date: 2018-08-02

Site: Elementary
Floor: 2

Building Name: St. David
Room #: 207
Last Re-Assessment: 2023-07-25

Area (sqft): 0

ASBESTOS																
System	Component	Material	Item	Covering	A*	V*	AP*	Good	Fair	Poor	Unit	Sample	Asbestos Type	Amount	Hazard	Friable
Ceiling	Acoustic Tile	Ceiling Tiles (lay-in), Small and Irregular Pinhole			C	Y		100			%	V0000	Non-Asbestos		None	
Ceiling	Acoustic Tile	Ceiling Tiles (lay-in), Short Fissure and Random Pinhole			C	Y		100			%	V0000	Non-Asbestos		None	
Floor		Vinyl Floor Tile and Mastic, Light Green Multi-Fleck			A	Y		100			%	V0000	Non-Asbestos		None	
Wall		Drywall and joint compound			A	Y		100			%	S0001C	None Detected	N.D.	None	
Wall ¹		Masonry			A	Y										

1 - Concrete Block

Client: Hamilton-Wentworth Catholic District Sch
Location: #2012 : Classroom
Survey Date: 2018-08-02

Site: Elementary
Floor: 2

Building Name: St. David
Room #: 206
Last Re-Assessment: 2023-07-25

Area (sqft): 0

ASBESTOS																
System	Component	Material	Item	Covering	A*	V*	AP*	Good	Fair	Poor	Unit	Sample	Asbestos Type	Amount	Hazard	Friable
Ceiling	Acoustic Tile	Ceiling Tiles (lay-in), Short Fissure and Random Pinhole			C	Y		100			%	V0000	Non-Asbestos		None	
Floor		Vinyl Floor Tile and Mastic, Light Green Multi-Fleck			A	Y		100			%	V0000	Non-Asbestos		None	
Floor		Mastic		Vinyl Floor Tile	D	N		100(7)			%	V9500	Presumed Asbestos		Presumed Asbestos	NF
Floor		Vinyl Floor Tile, Beige Multi-Fleck			A	Y		100			%	V0000	Non-Asbestos		None	
Wall		Drywall and joint compound			A	Y		100			%	V0001	None Detected	N.D.	None	
Wall ¹		Masonry			A	Y										

1 - Concrete Block

Client: Hamilton-Wentworth Catholic District Sch
Location: #2013 : Classroom
Survey Date: 2018-08-02

Site: Elementary
Floor: 2

Building Name: St. David
Room #: 205
Last Re-Assessment: 2023-07-25

Area (sqft): 0

ASBESTOS																
System	Component	Material	Item	Covering	A*	V*	AP*	Good	Fair	Poor	Unit	Sample	Asbestos Type	Amount	Hazard	Friable
Ceiling	Acoustic Tile	Ceiling Tiles (lay-in), Small and Irregular Pinhole			C	Y		100			%	V0000	Non-Asbestos		None	
Ceiling	Acoustic Tile	Ceiling Tiles (lay-in), Short Fissure and Random Pinhole			C	Y		100			%	V0000	Non-Asbestos		None	
Floor		Mastic		Vinyl Floor Tile	D	N		100(7)			%	V9500	Presumed Asbestos		Presumed Asbestos	NF
Floor		Vinyl Floor Tile, Beige Multi-Fleck			A	Y		100			%	V0000	Non-Asbestos		None	
Wall		Drywall and joint compound			A	Y		100			%	V0001	None Detected	N.D.	None	
Wall ¹		Masonry			A	Y										

1 - Concrete Block

Client: Hamilton-Wentworth Catholic District Sch
Location: #2014 : Classroom
Survey Date: 2018-08-02

Site: Elementary
Floor: 2

Building Name: St. David
Room #: 204
Last Re-Assessment: 2023-07-25

Area (sqft): 0

ASBESTOS																
System	Component	Material	Item	Covering	A*	V*	AP*	Good	Fair	Poor	Unit	Sample	Asbestos Type	Amount	Hazard	Friable
Ceiling	Acoustic Tile	Ceiling Tiles (lay-in), Small and Irregular Pinhole			C	Y		100			%	V0000	Non-Asbestos		None	
Ceiling	Acoustic Tile	Ceiling Tiles (lay-in), Short Fissure and Random Pinhole			C	Y		100			%	V0000	Non-Asbestos		None	
Floor		Mastic		Vinyl Floor Tile	D	N		100(7)			%	V9500	Presumed Asbestos		Presumed Asbestos	NF
Floor		Vinyl Floor Tile, Beige Multi-Fleck			A	Y		100			%	V0000	Non-Asbestos		None	
Wall		Drywall and joint compound			A	Y		100			%	S0001A	None Detected	N.D.	None	
Wall ¹		Masonry			A	Y										

1 - Concrete Block

Client: Hamilton-Wentworth Catholic District Sch
Location: #2015 : LRT Room
Survey Date: 2018-08-02

Site: Elementary
Floor: 2

Building Name: St. David
Room #:
Last Re-Assessment: 2023-07-25

Area (sqft): 0

ASBESTOS																
System	Component	Material	Item	Covering	A*	V*	AP*	Good	Fair	Poor	Unit	Sample	Asbestos Type	Amount	Hazard	Friable
Ceiling	Acoustic Tile	Ceiling Tiles (lay-in), Short Fissure and Random Pinhole			C	Y		100			%	V0000	Non-Asbestos		None	
Floor		Vinyl Floor Tile and Mastic, Light Green Multi-Fleck			A	Y		100			%	V0000	Non-Asbestos		None	
Floor		Mastic		Vinyl Floor Tile	D	N		100(7)			%	V9500	Presumed Asbestos		Presumed Asbestos	NF
Floor		Vinyl Floor Tile, Beige and Multi-Fleck			A	Y		100			%	V0000	Non-Asbestos		None	
Wall ¹		Masonry			A	Y										

1 - Concrete Block

Client: Hamilton-Wentworth Catholic District Sch
Location: #2016 : Server Room
Survey Date: 2018-08-02

Site: Elementary
Floor: 2

Building Name: St. David
Room #:
Last Re-Assessment: 2023-07-25

Area (sqft): 0

ASBESTOS																
System	Component	Material	Item	Covering	A*	V*	AP*	Good	Fair	Poor	Unit	Sample	Asbestos Type	Amount	Hazard	Friable
Ceiling	Acoustic Tile	Ceiling Tiles (lay-in), Short Fissure and Random Pinhole			C	Y		100			%	V0000	Non-Asbestos		None	
Floor		Vinyl Floor Tile and Mastic, Light Green Multi-Fleck			A	Y		100			%	V0000	Non-Asbestos		None	
Floor		Mastic		Vinyl Floor Tile	D	N		100(7)			%	V9500	Presumed Asbestos		Presumed Asbestos	NF
Floor		Vinyl Floor Tile, Beige Multi-Fleck			A	Y		100			%	V0000	Non-Asbestos		None	
Wall ¹		Masonry			A	Y										

1 - Concrete Block

Client: Hamilton-Wentworth Catholic District Sch
Location: #2017 : Classroom
Survey Date: 2018-08-02

Site: Elementary
Floor: 2

Building Name: St. David
Room #: 201
Last Re-Assessment: 2023-07-25

Area (sqft): 0

ASBESTOS																
System	Component	Material	Item	Covering	A*	V*	AP*	Good	Fair	Poor	Unit	Sample	Asbestos Type	Amount	Hazard	Friable
Ceiling	Acoustic Tile	Ceiling Tiles (lay-in), Short Fissure and Random Pinhole			C	Y		100			%	V0000	Non-Asbestos		None	
Floor		Mastic		Vinyl Floor Tile	D	N		100(7)			%	V9500	Presumed Asbestos		Presumed Asbestos	NF
Floor		Vinyl Floor Tile, Beige Multi-Fleck			A	Y		100			%	V0000	Non-Asbestos		None	
Wall ¹		Masonry			A	Y										

1 - Concrete Block

Client: Hamilton-Wentworth Catholic District Sch
Location: #2018 : Corridor
Survey Date: 2018-08-02

Site: Elementary
Floor: 2

Building Name: St. David
Room #:
Last Re-Assessment: 2023-07-25

Area (sqft): 0

ASBESTOS																
System	Component	Material	Item	Covering	A*	V*	AP*	Good	Fair	Poor	Unit	Sample	Asbestos Type	Amount	Hazard	Friable
Floor		Mastic		Vinyl Floor Tile	D	N		100(7)			%	V9500	Presumed Asbestos		Presumed Asbestos	NF
Floor		Vinyl Floor Tile, Beige Multi-Fleck			A	Y		100			%	V0000	Non-Asbestos		None	
Mechanical Equipment		None Found														
Wall		Drywall and joint compound			A	Y		100			%	V0002	None Detected	N.D.	None	

Client: Hamilton-Wentworth Catholic District Sch
Location: #2019 : Corridor
Survey Date: 2018-08-02

Site: Elementary
Floor: 2

Building Name: St. David
Room #:
Last Re-Assessment: 2023-07-25

Area (sqft): 0

ASBESTOS																
System	Component	Material	Item	Covering	A*	V*	AP*	Good	Fair	Poor	Unit	Sample	Asbestos Type	Amount	Hazard	Friable
Ceiling	Acoustic Tile	Ceiling Tiles (lay-in), Short Fissure and Random Pinhole			C	Y		100			%	V0000	Non-Asbestos		None	
Floor		Mastic		Vinyl Floor Tile	D	N		100(7)			%	V9500	Presumed Asbestos		Presumed Asbestos	NF
Floor		Vinyl Floor Tile, Beige Multi-Fleck			A	Y		100			%	V0000	Non-Asbestos		None	
Piping		Fibreglass			C	Y										
Wall		Drywall and joint compound			A	Y		100			%	V0002	None Detected	N.D.	None	

Client: Hamilton-Wentworth Catholic District Sch
Location: #2020 : Library
Survey Date: 2018-08-02

Site: Elementary
Floor: 2

Building Name: St. David
Room #:
Last Re-Assessment: 2023-07-25

Area (sqft): 0

ASBESTOS																
System	Component	Material	Item	Covering	A*	V*	AP*	Good	Fair	Poor	Unit	Sample	Asbestos Type	Amount	Hazard	Friable
Ceiling	Acoustic Tile	Ceiling Tiles (lay-in), Short Fissure and Random Pinhole			C	Y		100			%	V0000	Non-Asbestos		None	
Floor		Carpet			A	Y										
Piping		Fibreglass			C	Y										
Wall		Drywall and joint compound			A	Y		100			%	S0002A	None Detected	N.D.	None	

Client: Hamilton-Wentworth Catholic District Sch
Location: #2021 : Office
Survey Date: 2018-08-02

Site: Elementary
Floor: 2

Building Name: St. David
Room #:
Last Re-Assessment: 2023-07-25

Area (sqft): 0

ASBESTOS																
System	Component	Material	Item	Covering	A*	V*	AP*	Good	Fair	Poor	Unit	Sample	Asbestos Type	Amount	Hazard	Friable
Ceiling	Acoustic Tile	Ceiling Tiles (lay-in), Short Fissure and Random Pinhole			C	Y		100			%	V0000	Non-Asbestos		None	
Floor		Mastic		Vinyl Floor Tile	D	N		100(7)			%	V9500	Presumed Asbestos		Presumed Asbestos	NF
Floor		Vinyl Floor Tile, Beige Multi-Fleck			A	Y		100			%	V0000	Non-Asbestos		None	
Wall		Drywall and joint compound			A	Y		100			%	V0002	None Detected	N.D.	None	

Client: Hamilton-Wentworth Catholic District Sch
Location: #2022 : Reading Recovery
Survey Date: 2018-08-02

Site: Elementary
Floor: 2

Building Name: St. David
Room #:
Last Re-Assessment: 2023-07-25

Area (sqft): 0

ASBESTOS																
System	Component	Material	Item	Covering	A*	V*	AP*	Good	Fair	Poor	Unit	Sample	Asbestos Type	Amount	Hazard	Friable
Ceiling	Acoustic Tile	Ceiling Tiles (lay-in), Short Fissure and Random Pinhole			C	Y		100			%	V0000	Non-Asbestos		None	
Floor		Mastic		Vinyl Floor Tile	D	N		100(7)			%	V9500	Presumed Asbestos		Presumed Asbestos	NF
Floor		Vinyl Floor Tile, Beige Multi-Fleck			A	Y		100			%	V0000	Non-Asbestos		None	
Wall		Drywall and joint compound			A	Y		100			%	V0002	None Detected	N.D.	None	

Client: Hamilton-Wentworth Catholic District Sch
Location: #2023 : Girls Washroom
Survey Date: 2018-08-02

Site: Elementary
Floor: 2

Building Name: St. David
Room #:
Last Re-Assessment: 2023-07-25

Area (sqft): 0

ASBESTOS																
System	Component	Material	Item	Covering	A*	V*	AP*	Good	Fair	Poor	Unit	Sample	Asbestos Type	Amount	Hazard	Friable
Ceiling		Plaster			C	Y		100			%	V0000	Non-Asbestos		None	
Floor		Ceramic Tiles			A	Y										
Wall ¹		Masonry			A	Y										

1 - Concrete Block

Client: Hamilton-Wentworth Catholic District Sch
Location: #2024 : Boys Washroom
Survey Date: 2018-08-02

Site: Elementary
Floor: 2

Building Name: St. David
Room #:
Last Re-Assessment: 2023-07-25

Area (sqft): 0

ASBESTOS																
System	Component	Material	Item	Covering	A*	V*	AP*	Good	Fair	Poor	Unit	Sample	Asbestos Type	Amount	Hazard	Friable
Ceiling		Plaster			C	Y		100			%	V0000	Non-Asbestos		None	
Floor		Ceramic Tiles			A	Y										
Wall ¹		Masonry			A	Y										

1 - Concrete Block

Client: Hamilton-Wentworth Catholic District Sch
Location: #2025 : Classroom
Survey Date: 2018-08-02

Site: Elementary
Floor: 2

Building Name: St. David
Room #: 224
Last Re-Assessment: 2023-07-25

Area (sqft): 0

ASBESTOS																
System	Component	Material	Item	Covering	A*	V*	AP*	Good	Fair	Poor	Unit	Sample	Asbestos Type	Amount	Hazard	Friable
Ceiling	Acoustic Tile	Ceiling Tiles (lay-in), Short Fissure and Random Pinhole			C	Y		100			%	V0000	Non-Asbestos		None	
Ceiling	Acoustic Tile	Ceiling Tiles (lay-in), Small Irregular Pinhole			C	Y		100			%	V0000	Non-Asbestos		None	
Floor		Vinyl Floor Tile and Mastic, Light Green Multi-Fleck			A	Y		100			%	V0000	Non-Asbestos		None	
Piping		Fibreglass			C	Y										
Wall		Drywall and joint compound			A	Y		100			%	V0002	None Detected	N.D.	None	
Wall ¹		Masonry			A	Y										

1 - Concrete Block

Client: Hamilton-Wentworth Catholic District Sch
Location: #2026 : Classroom
Survey Date: 2018-08-02

Site: Elementary
Floor: 2

Building Name: St. David
Room #: 223
Last Re-Assessment: 2023-07-25

Area (sqft): 0

ASBESTOS																
System	Component	Material	Item	Covering	A*	V*	AP*	Good	Fair	Poor	Unit	Sample	Asbestos Type	Amount	Hazard	Friable
Ceiling	Acoustic Tile	Ceiling Tiles (lay-in), Short Fissure and Random Pinhole			C	Y		100			%	V0000	Non-Asbestos		None	
Ceiling	Acoustic Tile	Ceiling Tiles (lay-in), Small and Irregular Pinhole			C	Y		100			%	V0000	Non-Asbestos		None	
Floor		Mastic		Vinyl Floor Tile	D	N		100(7)			%	V9500	Presumed Asbestos		Presumed Asbestos	NF
Floor		Vinyl Floor Tile, Beige Multi-Fleck			A	Y		100			%	V0000	Non-Asbestos		None	
Piping		Fibreglass			C	Y										
Wall		Drywall and joint compound			A	Y		100			%	S0002C	None Detected	N.D.	None	
Wall ¹		Masonry			A	Y										

1 - Concrete Block

Client: Hamilton-Wentworth Catholic District Sch
Location: #2027 : Computer Lab
Survey Date: 2018-08-02

Site: Elementary
Floor: 2

Building Name: St. David
Room #:
Last Re-Assessment: 2023-07-25

Area (sqft): 0

ASBESTOS																
System	Component	Material	Item	Covering	A*	V*	AP*	Good	Fair	Poor	Unit	Sample	Asbestos Type	Amount	Hazard	Friable
Ceiling	Acoustic Tile	Ceiling Tiles (lay-in), Short Fissure and Random Pinhole			C	Y		100			%	V0000	Non-Asbestos		None	
Floor		Mastic		Vinyl Floor Tile	D	N		100(7)			%	V9500	Presumed Asbestos		Presumed Asbestos	NF
Floor		Vinyl Floor Tile, Beige Multi-Fleck			A	Y		100			%	V0000	Non-Asbestos		None	
Piping		Fibreglass			C	Y										
Wall		Drywall and joint compound			A	Y		100			%	S0002B	None Detected	N.D.	None	

Client: Hamilton-Wentworth Catholic District Sch
Location: #2028 : Classroom
Survey Date: 2018-08-02

Site: Elementary
Floor: 2

Building Name: St. David
Room #: 220
Last Re-Assessment: 2023-07-25

Area (sqft): 0

ASBESTOS																
System	Component	Material	Item	Covering	A*	V*	AP*	Good	Fair	Poor	Unit	Sample	Asbestos Type	Amount	Hazard	Friable
Ceiling	Acoustic Tile	Ceiling Tiles (lay-in), Short Fissure and Random Pinhole			C	Y		100			%	V0000	Non-Asbestos		None	
Floor		Vinyl Floor Tile and Mastic, Light Green Multi-Fleck			A	Y		100			%	V0000	Non-Asbestos		None	
Floor		Mastic		Vinyl Floor Tile	D	N		100(7)			%	V9500	Presumed Asbestos		Presumed Asbestos	NF
Floor		Vinyl Floor Tile, Beige Multi-Fleck			A	Y		100			%	V0000	Non-Asbestos		None	
Wall		Drywall and joint compound			A	Y		100			%	V0001	None Detected	N.D.	None	
Wall ¹		Masonry			A	Y										

1 - Concrete Block

Client: Hamilton-Wentworth Catholic District Sch
Location: #2029 : Classroom
Survey Date: 2018-08-02

Site: Elementary
Floor: 2

Building Name: St. David
Room #: 219
Last Re-Assessment: 2023-07-25

Area (sqft): 0

ASBESTOS																
System	Component	Material	Item	Covering	A*	V*	AP*	Good	Fair	Poor	Unit	Sample	Asbestos Type	Amount	Hazard	Friable
Ceiling	Acoustic Tile	Ceiling Tiles (lay-in), Short Fissure and Random Pinhole			C	Y		100			%	V0000	Non-Asbestos		None	
Floor		Vinyl Floor Tile and Mastic, Light Green Multi-Fleck			A	Y		100			%	V0000	Non-Asbestos		None	
Wall		Drywall and joint compound			A	Y		100			%	S0001B	None Detected	N.D.	None	
Wall ¹		Masonry			A	Y										

1 - Concrete Block

Client: Hamilton-Wentworth Catholic District Sch
Location: #2030 : Classroom
Survey Date: 2018-08-02

Site: Elementary
Floor: 2

Building Name: St. David
Room #: 218
Last Re-Assessment: 2023-07-25

Area (sqft): 0

ASBESTOS																
System	Component	Material	Item	Covering	A*	V*	AP*	Good	Fair	Poor	Unit	Sample	Asbestos Type	Amount	Hazard	Friable
Ceiling	Acoustic Tile	Ceiling Tiles (lay-in), Short Fissure and Random Pinhole			C	Y		100			%	V0000	Non-Asbestos		None	
Floor		Vinyl Floor Tile and Mastic, Light Green Multi-Fleck			A	Y		100			%	V0000	Non-Asbestos		None	
Wall		Drywall and joint compound			A	Y		100			%	V0001	None Detected	N.D.	None	
Wall ¹		Masonry			A	Y										

1 - Concrete Block

Client: Hamilton-Wentworth Catholic District Sch
Location: #2031 : Classroom
Survey Date: 2018-08-02

Site: Elementary
Floor: 2

Building Name: St. David
Room #: 217
Last Re-Assessment: 2023-07-25

Area (sqft): 0

ASBESTOS																
System	Component	Material	Item	Covering	A*	V*	AP*	Good	Fair	Poor	Unit	Sample	Asbestos Type	Amount	Hazard	Friable
Ceiling	Acoustic Tile	Ceiling Tiles (lay-in), Short Fissure and Random Pinhole			C	Y		100			%	V0000	Non-Asbestos		None	
Floor		Vinyl Floor Tile and Mastic, Light Green Multi-Fleck			A	Y		100			%	V0000	Non-Asbestos		None	
Wall		Drywall and joint compound			A	Y		100			%	V0001	None Detected	N.D.	None	
Wall ¹		Masonry			A	Y										

1 - Concrete Block

Legend:

Sample number		Units		Other	
S####	Asbestos sample collected	SF	Square feet	A	Access
V####	Material visually similar to numbered sample collected	LF	Linear feet	V	Visible
V0000	Known non-asbestos material	EA	Each	AP	Air Plenum
V9000	Visually identified as an asbestos material	%	Percentage	F	Friable material
V9500	Material is presumed to be an asbestos material			NF	Non Friable material
				PF	Potentially Friable material

Access	
A	Accessible to all building occupants
B	Accessible to maintenance and operations staff without a ladder
C	Accessible to maintenance and operations staff with a ladder. Also rarely entered, locked areas
D	Not normally accessible

Condition	
Good	No visible damage or deterioration
Fair	Minor, repairable damage, cracking, delamination or deterioration
Poor	Irreparable damage or deterioration with exposed and missing material

Visible	
Y	The material is visible when standing on the floor of the room, without the removal or opening of other building components (e.g. ceiling tiles or access panels).
N	The material is not visible to view when standing on the floor of the room and requires the removal of a building component (e.g. ceilings tiles or access panels) to view and access. Includes rarely entered crawlspaces, attic spaces, etc. Observations will be limited to the extent visible from the access points.

Air Plenum	
Yes or No	The material is in a return air plenum or in a direct airstream or there is evidence of air erosion (e.g. duct for heating or cooling blowing directly on or across an ACM). This field is only completed where Air Plenum consideration is required by regulation.

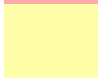
Colour Coding	
	The material is known to contain regulated concentrations of asbestos; either by analytical results or visible identification (use of the V9000 code).
	The material is presumed to contain asbestos; based on visual appearances; typically a material known to historically contain asbestos; however, not sampled due to limited access or the destructive nature of the sampling.

Action					
(1)	Clean up of ACM Debris	(2)	Precautions for Access Which may Disturb ACM Debris	(3)	ACM removal
(4)	Precautions for Work Which may Disturb ACM in Poor Condition	(5)	Proactive ACM removal (Minimum repair required for fair condition)	(6)	ACM repair
(7)	Management program and surveillance				